

CENTURION[®]

STONE

Technical Data

- Descriptions -

- Patterns -

- Dimensions -

ADDRESS PLAQUE #790, 791

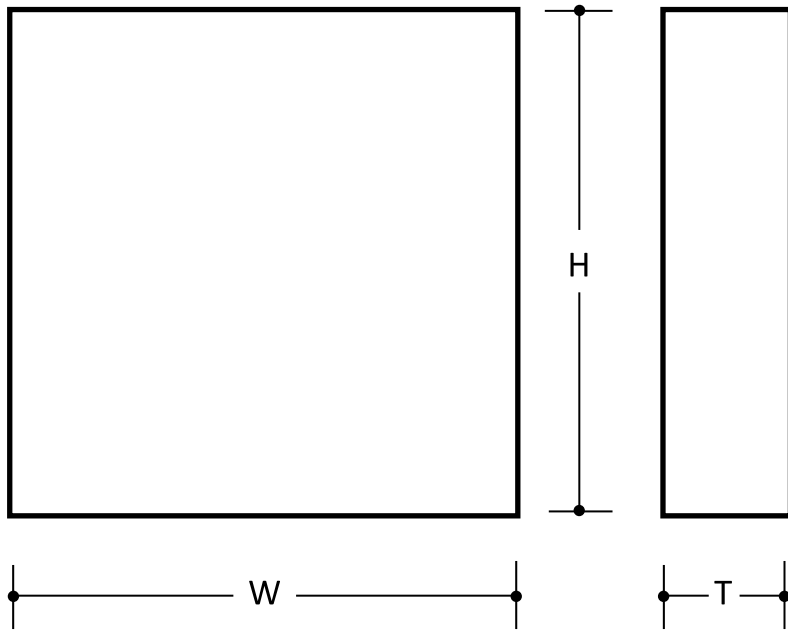

Engraving Not Provided

PATTERN DESCRIPTIONS AND DIMENSIONS

Pattern	Texture	Code	T	H	W
ADDRESS PLAQUE, SMALL	Smooth face, chiseled edges.	790	1 1/2"	8 1/4"	17"
ADDRESS PLAQUE, GRANDE	Smooth face, chiseled edges.	791	1 1/2"	10 1/2"	15"

*thickness, height and width dimensions may have +/- tolerance due to hand casting of product

*trimming and shaping of pieces may be required around openings as well as maintaining a level and coarsed pattern

* certain patterns are designed by Centurion to be laid with a mortar joint-like Rubble. For those patterns, the coverage area includes the mortar joint. For patterns designed to be drystacke- like Ledge, the coverage area does not include a mortar joint.

Standard Accessory Color Line	Color Code
APPALACHIA	250-25
BROWN	200-25
CHARDONAY	180-65
KENTUCKY	260-15
PENNSYLVANIA	800-25
MESA VALLEY	930-65
MISSOURI	100-15
PLAIN	330-20
SUEDE	185-65
TENNESSEE	010-15
TEXAS	310-10
TULSA	791-15

Packaging/Skid		Weights/Skid(Avg)
Item #	Pcs	Lbs.
790	68	1156
791	51	867



ASHLAR #230

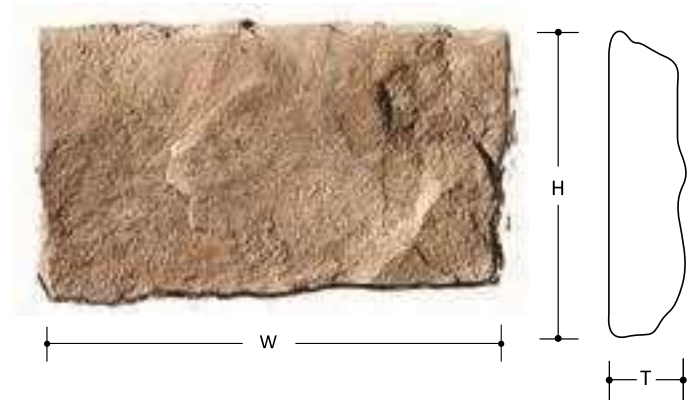

PATTERN DESCRIPTIONS AND DIMENSIONS

Pattern	Texture	Installation	T	H	W	Joint
ASHLAR	Assortment of sizes and shapes in an organized pattern. Face of pieces flat but with texture.	Installed with the longest side down and level. A joint is required with this pattern.	1 1/4" to 2"	2 1/4" to 11"	5 3/4" to 20 3/4"	3/4"

*thickness, height and width dimensions may have +/- tolerance due to hand casting of product

*trimming and shaping of pieces may be required around openings as well as maintaining a level and coarsed pattern

*Certain patterns are designed by Centurion to be laid with a mortar joint- like Rubble. For those patterns, the coverage area includes the mortar joint. For patterns designed to be drystacked- like Ledge, the coverage area does not include mortar joint.

Standard Color Line	Product Code	Recommended Accessory Color	Accessory Color Code
BUCKS COUNTY	230-701-25	PENNSYLVANIA	800-25
KENTUCKY	230-260-15	KENTUCKY / TENNESSEE	260-15 / 010-15
ODESSA FALLS	230-365-25	CALIFORNIA BASE MIX ONLY	223-25
PENNSYLVANIA	230-800-25	PENNSYLVANIA	800-25

Packaging/Skid	Weights/Skid (Avg)	
	Sq.Ft.	Lbs.
Flats	100	1060
Corners	80	1150



BEVELED COLUMN CAP #580

#867

#868

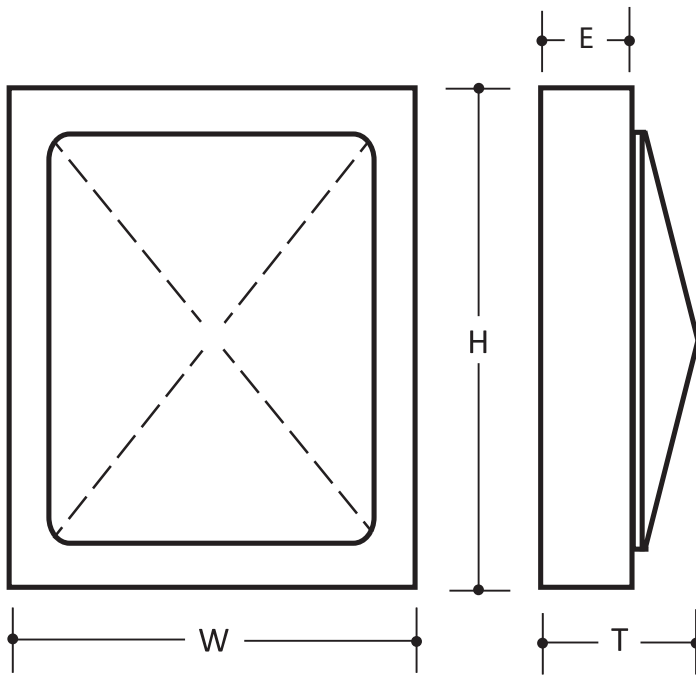

PATTERN DESCRIPTIONS AND DIMENSIONS

Pattern	Texture	Code	T	H	W	Edge
BEVELED COLUMN CAP	Chiseled top and edges, no step down on top.	580	5"	20"	20"	2.5"
	Smooth top and chiseled edges.	867	9"	24"	24"	4"
	Smooth top and chiseled edges.	868	9"	28"	28"	4"

*thickness, height and width dimensions may have +/- tolerance due to hand casting of product

*trimming and shaping of pieces may be required around openings as well as maintaining a level and coarsed pattern

*Certain patterns are designed by Centurion to be laid with a mortar joint-like Rubble. For those patterns, the coverage area includes the mortar joint. For patterns designed to be drystack-like Ledge, the coverage area does not include a mortar joint

Packaging/Skid		Weights/Skid(Avg)
Item #	Pcs.	Lbs.
580	14	1358
867	2	325
868	2	430

Standard Accessory Color Line	Color Code
APPALACHIA	250-25
BROWN	200-25
CHARDONAY	180-65
KENTUCKY	260-15
PENNSYLVANIA	800-25
MESA VALLEY	930-65
MISSOURI	100-15
PLAIN	330-20
SUEDE	185-65
TENNESSEE	010-15
TEXAS	310-10
TULSA	791-15



BEVELED WALL CAP #861, 862

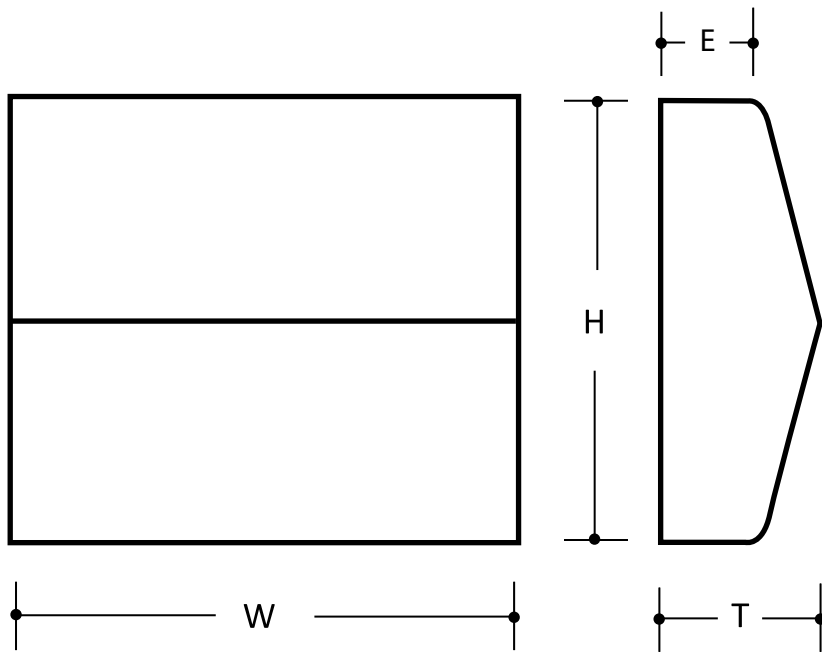

PATTERN DESCRIPTIONS AND DIMENSIONS

Pattern	Texture	Code	T	H	W	Edge
BEVELED WALL CAP	Slate face chiseled edge.	861	3"	12"	24"	2"
		862	3"	16"	24"	2"

*thickness, height and width dimensions may have +/- tolerance due to hand casting of product

*trimming and shaping of pieces may be required around openings as well as maintaining a level and coarsed pattern

*Certain patterns are designed by Centurion to be laid with a mortar joint-like Rubble. For those patterns, the coverage area includes the mortar joint. For patterns designed to be drystack-like Ledge, the coverage area does not include a mortar joint

Packaging/Skid		Weights/Skid(Avg)
Item #	Pcs.	Lbs.
861	36	1880
862	26	2002

Standard Accessory Color Line	Color Code
APPALACHIAN	250-25
BROWN	200-25
CHARDONAY	180-65
KENTUCKY	260-15
PENNSYLVANIA	800-25
MESA VALLEY	930-65
MISSOURI	100-15
PLAIN	330-20
SUEDE	185-65
TENNESSEE	010-15
TEXAS	310-10
TULSA	791-15



BILTMORE #400

Flat Pattern	
*Size	Pcs
A-6x24	1
B-6x18	2
C-6x15	1
D-6x12	1
E-9x12	2
F-12x12	2
G-12x21	1
H-9x18	1

Corner Pattern	
*Size	Pcs
#1 6x6x12	1
#2 3x9x12	1
#3 3x9x9	2
#4 3x6x9	1

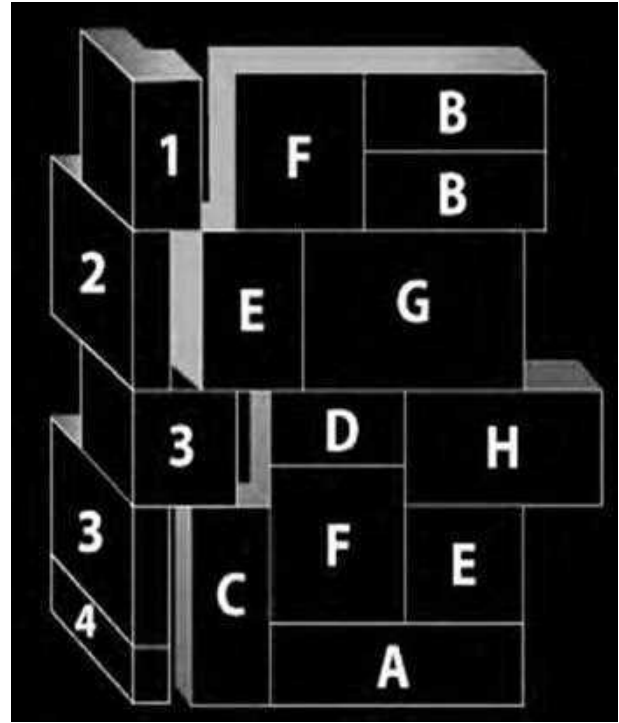

PATTERN DESCRIPTIONS AND DIMENSIONS

Pattern	Texture	T	H	W	Joint
BILTMORE	A weathered slate appearance with sawcut edges.	1" to 1 1/4"	6" to 11 3/4"	11 3/4" to 23 1/2"	Drystack

*thickness, height and width dimensions may have +/- tolerance due to hand casting of product

*trimming and shaping of pieces may be required around openings as well as maintaining a level and coarsed pattern

* Certain patterns are designed by Centurion to be laid with a mortar joint-like Rubble. For those patterns, the coverage area includes the mortar joint. For patterns designed to be drystacked-like Ledge, the coverage area does not include a mortar joint

Standard Color Line	Product Code	Recommended Accessory Color	Accessory Color Code
PENNSYLVANIA	400-800-25	PENNSYLVANIA	800-25
PLAIN	400-330-20	PLAIN	330-20
TEXAS	400-310-10	TEXAS	310-10

Packaging/Skid	Weights/Skid (Avg)	
	Sq.Ft.	Lbs.
Flats	114	1085
Corners	128	935



Brick Stone # 110

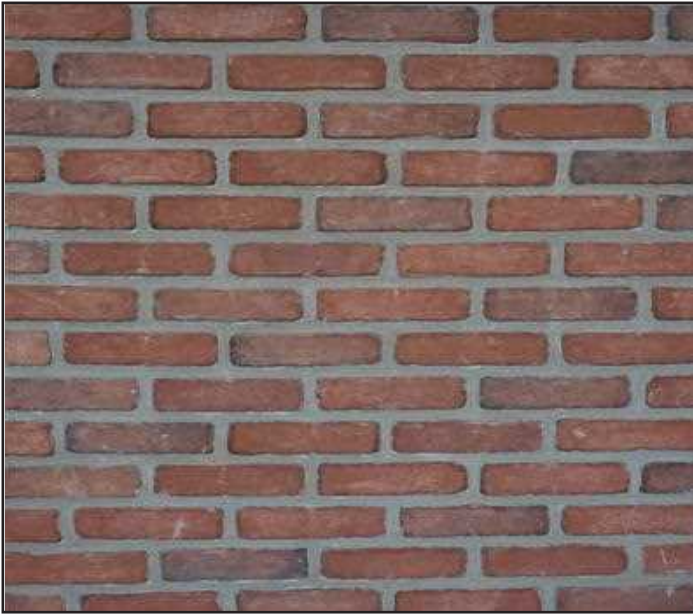

PATTERN DESCRIPTIONS AND DIMENSIONS

Pattern	Texture	Installation	T	H	W	Joint	
Brickstone	Tumbled Modular Brick	Coarsed Layout with 1/2" Mortar Joint	5/8"	2 1/4"	7 1/2"	1/2"	
Brickstone Corners	Tumbled Modular Brick	Coarsed Layout with 1/2" Mortar Joint	5/8"	2 1/4"	ID Long	Short	1/2"
					OD	7 1/2"	

Standard Color Line	Product Code		
Beige	110-56255		
Chicago	110-63925		
Lexington	110-66925		
Midnight	110-50847		
Mist	110-74315		
White Wash	110-77315		

*thickness, height and width dimensions may have +/- tolerance due to hand casting of product, with this specific product the tolerance is +/- : 1/4" ; And is also recommended to be installed with a 1/2" "Setting bed"

*trimming and shaping of pieces may be required around openings as well as maintaining a level and coarsed pattern

*Certain patterns are designed by Centurion to be laid with a mortar joint-like Rubble. For those patterns, the coverage area includes the mortar joint. For patterns designed to be drystack-like Ledge, the coverage area does not include a mortar joint

	Packaging/Skid	Weights (Avg)	
	Sq.Ft.	Lbs.	
Flats	136	610	
Corners	88	425	



BRICK TRIM - 4 PIECE #755

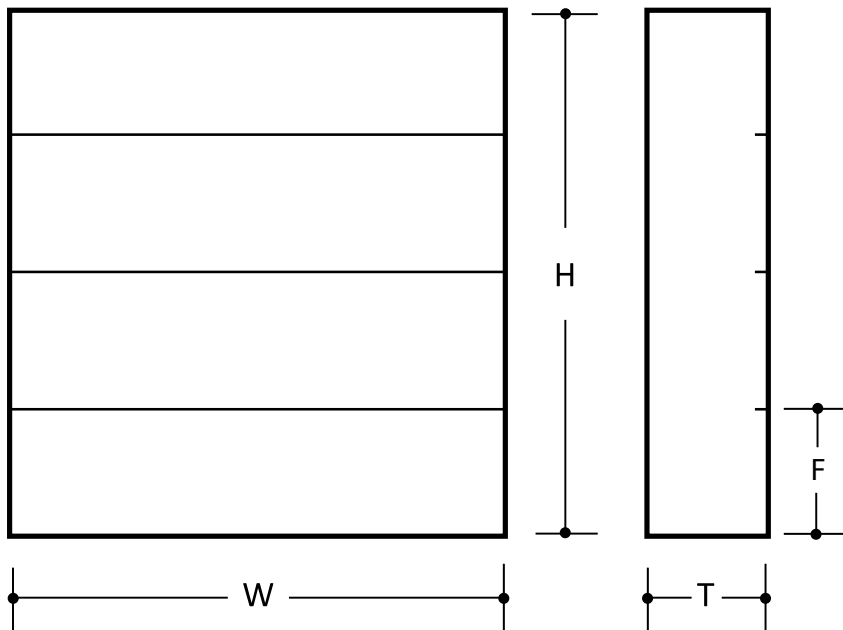

PATTERN DESCRIPTIONS AND DIMENSIONS

Pattern	Texture	Code	T	H	W	Edge
BRICK TRIM 4 PIECE	Used Brick Texture	755	2"	10"	7.5"	2"

*thickness, height and width dimensions may have +/- tolerance due to hand casting of product

*trimming and shaping of pieces may be required around openings as well as maintaining a level and coarsed pattern

*Certain patterns are designed by Centurion to be laid with a mortar joint-like Rubble. For those patterns, the coverage area includes the mortar joint. For patterns designed to be drystack-like Ledge, the coverage area does not include a mortar joint

Packaging/Skid		Weights/Skid(Avg)
Item #	Pcs.	Lbs.
755	90	810

Standard Accessory Color Line	Color Code
APPALACHIAN	250-25
BROWN	200-25
CHARDONAY	180-65
KENTUCKY	260-15
PENNSYLVANIA	800-25
MESA VALLEY	930-65
MISSOURI	100-15
PLAIN	330-20
SUEDE	185-65
TENNESSEE	010-15
TEXAS	310-10
TULSA	791-15



#186- 2" BROOKSTONE



#187- 4" BROOKSTONE



#188- 6" BROOKSTONE



#189- BROOKSTONE BLEND



PATTERN DESCRIPTIONS AND DIMENSIONS

Pattern	Texture	Installation	T	H	W	Joint
BROOKSTONE	The Brookstone pattern is modeled to replicate the sharp lines found in a guillotine-cut natural stone.	The guillotine-cut stone was designed for a dry stack installation.	1" to 1 1/2"	2" to 6"	6" to 16"	Drystack

* thickness, height and width dimensions may have +/- tolerance due to hand casting of product
 * trimming and shaping of pieces may be required around openings as well as maintaining a level and coarsed pattern
 * Certain patterns are designed by Centurion to be laid with a mortar joint-like Rubble. For those patterns, the coverage area includes the mortar joint. For patterns designed to be drystack-like Ledge, the coverage area does not include a mortar joint

Standard Color Line	Product Code	Recommended Accessory Color	Accessory Color Code
CREAM	189-604-10	TEXAS	310-10
ROCKY	189-591-04	ALPINE	466-04
SHORELINE	189-408-15	COASTAL	584-15

	Packaging/Skid		Weights/Skid (Avg)	
	Sq.Ft.	Lbs.	Sq.Ft.	Lbs.
Flats	88	930		
Corners	80	920		



CANYON LEDGE #280



PATTERN DESCRIPTIONS AND DIMENSIONS

Pattern	Texture	Installation	T	H	W	Joint
CANYON LEDGE	Well worn look of eroded texture.	Install in a horizontal pattern with mortar joint.	1 1/2" to 3"	1 1/2" to 4"	5 1/2" to 19"	3/4"

*thickness, height and width dimensions may have +/- tolerance due to hand casting of product

*trimming and shaping of pieces may be required around openings as well as maintaining a level and coarsed pattern

*Certain patterns are designed by Centurion to be laid with a mortar joint-like Rubble. For those patterns, the coverage area includes the mortar joint. For patterns designed to be drystack-like Ledge, the coverage area does not include a mortar joint

Standard Color Line	Product Code	Recommended Accessory Color	Accessory Color Code
APPALACHIAN	280-250-15	APPALACHIAN	250-15
BROWN	280-200-25	BROWN	200-25
BUCKS COUNTY	280-701-25	PENNSYLVANIA	800-25
ENGLISH	280-270-15	APPALACHIAN	250-15
PENNSYLVANIA	280-800-25	PENNSYLVANIA	800-25
KENTUCKY	280-260-15	KENTUCKY / TENNESSEE	260-15 / 010-15
SOUTHERN WHEAT	280-801-25	BROWN	200-25

Packaging/Skid	Weights (Avg)	
	Sq.Ft.	Lbs.
Flats	92	950
Corners	72	900



CATHEDRAL STONE # 140

Flats*			
Piece	Height	Width	Pcs Req
A	12"	12"	1
B	12"	24"	1
C	6"	15"	2
D	4"	12"	2
E	4"	15"	2
F	8"	24"	2
G	4"	24"	1
H	12"	15"	1
I	8"	12"	1
J	6"	12"	2
K	6"	24"	1
L	8"	15"	1

FEATURES:

- Can be installed in random or repeating pattern for quick installation with minimum cutting.
- 90 degree corners available.
- Pattern sized with half inch mortar joint.
- Convenient, easy handling packaging.

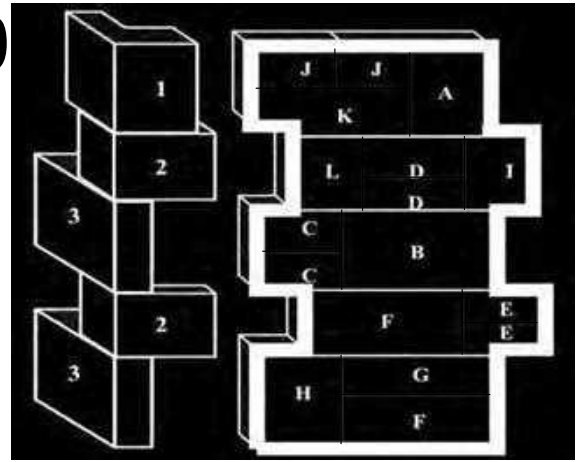

Corner		Size*	Lin. Ft.		Sq. Ft.	C to F
#	Pcs		Pc.	Total	Total	Factor
#1	1	6 x 9 x 12	12"	1	.79	
#2	2	4 x 9 x 8	8"	1.3	.45	
#3	2	4 x 9 x 12	12"	2	.67	
APPROXIMATE COVERAGE				4.3	1.9	X .44

PATTERN DESCRIPTIONS AND DIMENSIONS

Pattern	Texture	T	H	W	Joint
CATHEDRAL STONE	Pitched faced stone, saw cut edges. Thickest of the pattern stones.	1 1/4" to 2"	3 1/4" to 11"	11" to 22 1/2"	1/2"

Standard Color Line	Product Code	Recommended Accessory Color	Accessory Color Code
PENNSYLVANIA	140-800-25	PENNSYLVANIA	800-25
PLAIN	140-330-20	PLAIN	330-20
SAGE VALLEY	140-710-25	PENNSYLVANIA	800-25

Packaging/Skid	Weights/Skid (Avg.)	
	Sq.Ft.	Lbs.
Flats	110	1030
Corners	80	820

*thickness, height and width dimensions may have +/- tolerance due to hand casting of product

*trimming and shaping of pieces may be required around openings as well as maintaining a level and coarsed pattern

* Certain patterns are designed by Centurion to be laid with a mortar joint-like Rubble. For those patterns, the coverage area includes the mortar joint. For patterns designed to be drystacked-like Ledge, the coverage area does not include a mortar joint

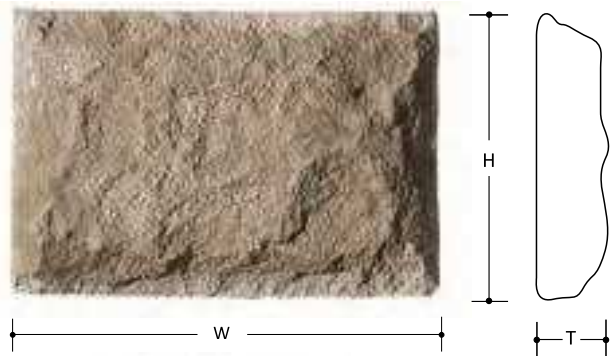

CENTURION CASTLE ROCK #070

FEATURES:

- Can be installed in random or repeating pattern for quick installation with minimum cut
- 90 degree corners available.
- Average thickness of one and one fourth inches.
- Pattern sized with three quarter inch mortar joint.
- Convenient, easy handling packaging.

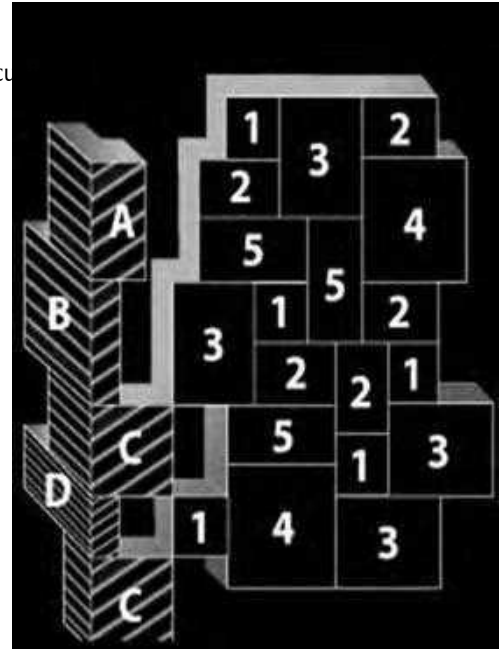

Flats*		
#	Size	Pcs
1	5.5 x 5.5	5
2	5.5 x 8.5	7
3	8.5 x 11.5	4
4	11.5 x 11.5	2
5	5.5 x 11.5	3

Corner		Size*	Lin. Ft.	Sq. Ft.	C to F	
#	Pcs		Pc.	Total	Factor	
A	4	6 x 6 x 12	12"	4	3.2	
B	4	3 x 12 x 12	12"	4	3.2	
C	4	3 x 9 x 9	9"	6	4.75	
D	4	3 x 9 x 6	6"	2	1.58	
APPROXIMATE COVERAGE				16	12.73	X .80

PATTERN DESCRIPTIONS AND DIMENSIONS

Pattern	Texture	T	H	W	Joint
CENTURION CASTLE ROCK	Flat profile weathered face texture formal looking stone.	3/4" to 1 3/4"	5 1/2" to 11 1/2"	5 1/2" to 11 1/2 "	3/4"

Standard Color Line	Product Code	Recommended Accessory Color	Accessory Color Code
BUCKS COUNTY	070-701-25	PENNSYLVANIA	800-25
GRAY	070-030-45	GRAY	030-45
KENTUCKY	070-260-15	KENTUCKY / TENNESSEE	260-15 / 010-15
PENNSYLVANIA	070-800-25	PENNSYLVANIA	800-25

Packaging/Skid	Weights/Skid (Avg.)	
	Sq.Ft.	Lbs.
Flats	126	920
Corners	128	1120

*thickness, height and width dimensions may have +/- tolerance due to hand casting of product
 *trimming and shaping of pieces may be required around openings as well as maintaining a level and coarsed pattern
 * Certain patterns are designed by Centurion to be laid with a mortar joint-like Rubble. For those patterns, the coverage area includes the mortar joint. For patterns designed to be drystack-like Ledge, the coverage area does not include a mortar joint



CHEROKEE BLEND #450



Blend of:
Ashlar, Cutface & Ledge

PATTERN DESCRIPTIONS AND DIMENSIONS

Pattern	Texture	Installation	T	H	W	Joint
CHEROKEE BLEND	Predominately square & rectangular design.	Installed in a random pattern with long side down.	1 1/4" to 2 1/4"	1" to 10 1/2"	4" to 20 3/4"	Drystack

*thickness, height and width dimensions may have +/- tolerance due to hand casting of product

*trimming and shaping of pieces may be required around openings as well as maintaining a level and coarsed pattern

*Certain patterns are designed by Centurion to be laid with a mortar joint-like Rubble. For those patterns, the coverage area includes the mortar joint. For patterns designed to be drystacked-like Ledge, the coverage area does not include a mortar joint

Standard Color Line	Product Code	Recommended Accessory Color	Accessory Color Code
BUCKS COUNTY	450-701-25	PENNSYLVANIA	800-25
KENTUCKY	450-260-15	KENTUCKY / TENNESSEE	260-15 / 010-15
PENNSYLVANIA	450-800-25	PENNSYLVANIA	800-25
SUEDE	450-185-65	MESA VALLEY / SUEDE	930-65 / 185-65

Packaging/Skid	Weights/Skid (Avg.)	
	Sq.Ft.	Lbs.
Flats	88	970
Corners	80	900



CHEYENNE #480

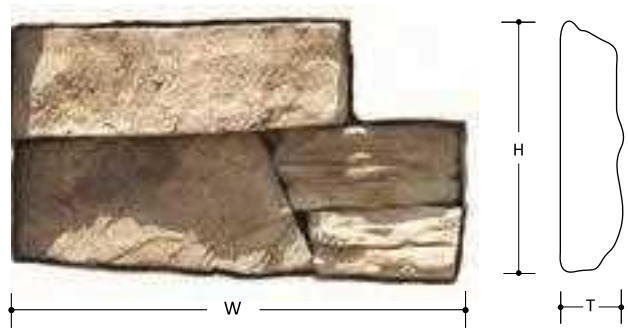

Blend of:
Canyon Ledge, Palos Verde & Weatheredge

PATTERN DESCRIPTIONS AND DIMENSIONS

Pattern	Texture	Installation	T	H	W	Joint
CHEYENNE	Predominately square & rectangular design.	Installed in a random pattern with long side down.	1" to 3"	1 1/4" to 15 1/2"	5" to 23"	Drystack

Standard Color Line	Product Code	Recommended Accessory Color	Accessory Color Code
BUCKS COUNTY	480-701-25	PENNSYLVANIA	800-25
KENTUCKY	480-260-15	KENTUCKY / TENNESSEE	260-15 / 010-15
PENNSYLVANIA	480-800-25	PENNSYLVANIA	800-25
SUEDE	480-185-65	MESA VALLEY / SUEDE	930-65 / 185-65

*thickness, height and width dimensions may have +/- tolerance due to hand casting of product

*trimming and shaping of pieces may be required around openings as well as maintaining a level and coarsed pattern

* Certain patterns are designed by Centurion to be laid with a mortar joint-like Rubble. For those patterns, the coverage area includes the mortar joint. For patterns designed to be drystack-like Ledge, the coverage area does not include a mortar joint

Packaging/Skid	Weights/Skid (Avg.)	
	Sq.Ft.	Lbs.
Flats	94	900
Corners	80	990



CHISELED WATER EDGE #875

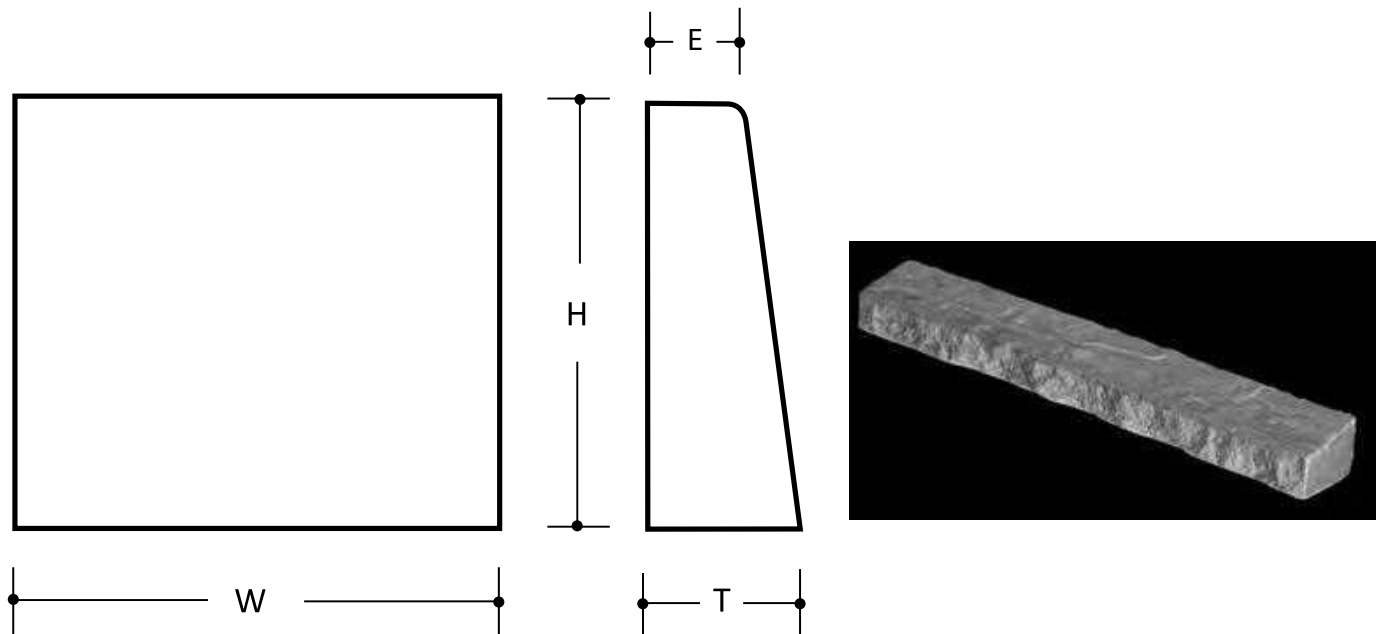

PATTERN DESCRIPTIONS AND DIMENSIONS

Pattern	Texture	Code	T	H	W	Edge
CHISELED WATER EDGE	Slate top. Chiseled front edge.	875	2.25"	3"	24"	1.75"

*thickness, height and width dimensions may have +/- tolerance due to hand casting of product

*trimming and shaping of pieces may be required around openings as well as maintaining a level and coarsed pattern

*Certain patterns are designed by Centurion to be laid with a mortar joint-like Rubble. For those patterns, the coverage area includes the mortar joint. For patterns designed to be drystack-like Ledge, the coverage area does not include a mortar joint

Packaging/Skid		Weights/Skid
Item #	Pcs.	Lbs.
875	66	660



Standard Accessory Color Line	Color Code
APPALACHIA	250-25
BROWN	200-25
CHARDONAY	180-65
KENTUCKY	260-15
PENNSYLVANIA	800-25
MESA VALLEY	930-65
MISSOURI	100-15
PLAIN	330-20
SUEDE	185-65
TENNESSEE	010-15
TEXAS	310-10
TULSA	791-15

COACH LIGHT TRIM #885, 887

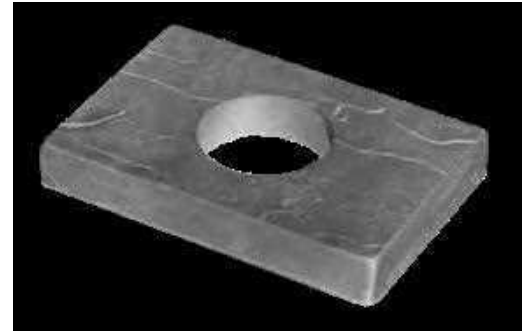
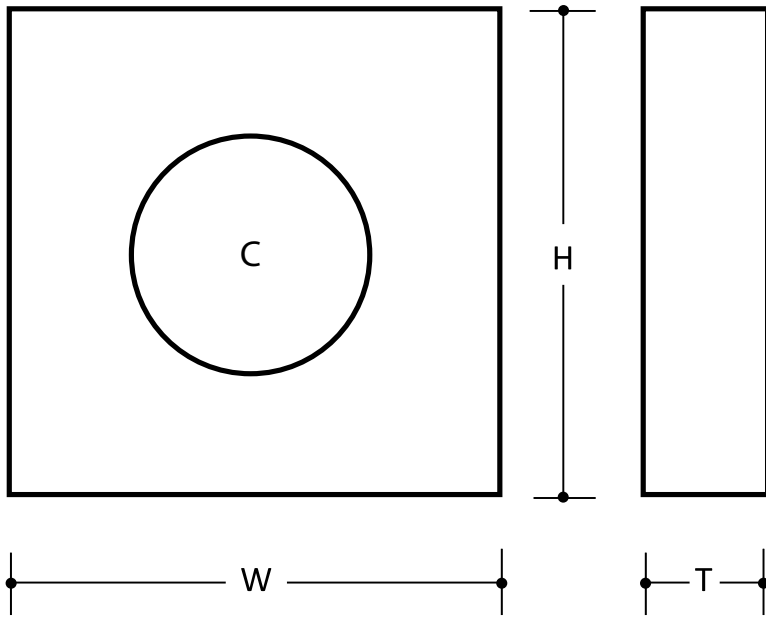

PATTERN DESCRIPTIONS AND DIMENSIONS

Pattern	Texture	Code	T	H	W	C
COACH LIGHT TRIM SMALL	Slate face	885	1.5"	6.75"	7.75"	4.25"
COACH LIGHT TRIM LARGE		887	1.5"	8"	12"	4.25"

*thickness, height and width dimensions may have +/- tolerance due to hand casting of product

*trimming and shaping of pieces may be required around openings as well as maintaining a level and coarsed pattern

*Certain patterns are designed by Centurion to be laid with a mortar joint-like Rubble. For those patterns, the coverage area includes the mortar joint. For patterns designed to be drystack-like Ledge, the coverage area does not include a mortar joint

Packaging		Weights/Skid	
#	Pcs./Skid	Pcs/Box	Lbs.
885	120	8	600
887	120	4	1080

Standard Accessory Color Line	Color Code
APPALACHIA	250-25
BROWN	200-25
CHARDONAY	180-65
KENTUCKY	260-15
PENNSYLVANIA	800-25
MESA VALLEY	930-65
MISSOURI	100-15
PLAIN	330-20
SUEDE	185-65
TENNESSEE	010-15
TEXAS	310-10
TULSA	791-15



Creekstone Blend #425

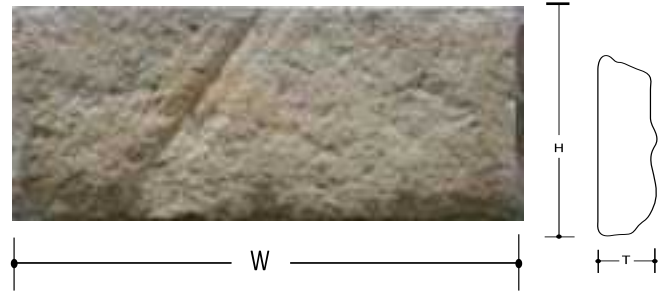

*thickness, height and width dimensions may have +/- tolerance due to hand casting of product
 *trimming and shaping of pieces may be required around openings as well as maintaining a level and coarsed pattern
 *Certain patterns are designed by Centurion to be laid with a mortar joint-like Rubble. For those patterns, the coverage area includes the mortar joint. For patterns designed to be drystack-like Ledge, the coverage area does not include a mortar joint

PATTERN DESCRIPTIONS AND DIMENSIONS

Pattern	Texture	Installation	T	H	W	Rec Joint
Creekstone	The Creekstone Pattern is designed to replicate the sharp lines found in a guillotine cut natural stone.	The Guillotine cut stone was designed for a 3/4" mortar joint installation	3/4" to 1 1/2"	6" to 16"	1 1/2" to 6"	3/4" joint

Standard Color Line	Product Code	Recommended Accessory Color	Accessory Color Code
APPALACHIAN	150-250-15	APPALACHIAN	250-15
BROWN	150-200-25	BROWN	200-25
BUCKS COUNTY	150-701-25	PENNSYLVANIA	800-25
COASTAL	150-584-15	COASTAL	584-15
GRAY	150-030-45	GRAY	030-45
HERMITAGE	150-342-15	COASTAL	584-15
KENTUCKY	150-260-15	KENTUCKY / TENNESSEE	260-150 / 010-15
LOUISVILLE	150-262-15	KENTUCKY / TENNESSEE	260-15 / 010-15
NORRIS GRAY	150-817-15	NORRIS GRAY	817-15
Oxford	150-469-20	Oxford	469-20
MT. RUNDLE NO ACCENT	150-492-70	MT. RUNDLE	490-70
SUEDE	150-185-65	MESA VALLEY / SUEDE	930-65 / 185-65
TEXAS	150-310-10	TEXAS	310-10

Packaging/Skid	Weights/Skid (Avg.)	
	Sq.Ft.	Lbs.
Flats	112	850
Corners	96	550



CUTFACE #270



PATTERN DESCRIPTIONS AND DIMENSIONS

Pattern	Texture	Installation	T	H	W	Joint
CUTFACE	Guillotine cut with deep chiseled face.	Installed in a horizontal pattern, sizes for easy installation.	1 1/4" to 2 1/4"	1" to 5 1/2"	4" to 19"	Drystack

Standard Color Line	Product Code	Recommended Accessory Color	Accessory Color Code
BROWN	270-200-25	BROWN	200-25
BUCKS COUNTY	270-701-25	PENNSYLVANIA	800-25
DOVE	270-031-45	GRAY	030-45
GRAY	270-030-45	GRAY	030-45
KENTUCKY	270-260-15	KENTUCKY / TENNESSEE	260-15 / 010-15
LOUISVILLE	270-262-15	KENTUCKY / TENNESSEE	260-15 / 010-15
OXFORD	270-469-20	OXFORD	469-20
PENNSYLVANIA	270-800-25	PENNSYLVANIA	800-25
SUEDE	270-185-65	MESA VALLEY / SUEDE	930-65 / 185-65
TULSA	270-791-15	TULSA	791-15

Packaging/Skid	Weights/Skid (Avg.)	
	Sq.Ft.	Lbs.
Flats	88	940
Corners	80	885

*thickness, height and width dimensions may have +/- tolerance due to hand casting of product

*trimming and shaping of pieces may be required around openings as well as maintaining a level and coarsed pattern

*Certain patterns are designed by Centurion to be laid with a mortar joint-like Rubble. For those patterns, the coverage area includes the mortar joint. For patterns designed to be drystack-like Ledge, the coverage area does not include a mortar joint



DESIGN SERIES #290



PATTERN DESCRIPTIONS AND DIMENSIONS

Pattern	Texture	T	H	W	Joint
DESIGN SERIES	Versatile pattern with uniform height pieces.	1" to 1 3/4"	1 3/4"	4" to 16"	Drystack

Standard Color Line	Product Code	Recommended Accessory Color	Accessory Color Code
AUSTIN	290-647-10	TEXAS	310-10
BUCKS COUNTY	290-701-25	PENNSYLVANIA	800-25
CHARDONAY	290-180-65	CHARDONAY	180-65
GRAY	290-030-45	GRAY	030-45
KENTUCKY	290-260-15	KENTUCKY / TENNESSEE	260-15 / 010-15
LOUISVILLE	290-262-15	KENTUCKY / TENNESSEE	260-15 / 010-15
MESA VALLEY	290-930-65	MESA VALLEY	930-65
PENNSYLVANIA	290-800-25	PENNSYLVANIA	800-25
TULSA	290-791-15	TULSA	791-15

Packaging/Skid	Weights/Skid (Avg.)	
	Sq.Ft.	Lbs.
Flats	88 sf	850
Corner	72 Lf	580

*thickness, height and width dimensions may have +/- tolerance due to hand casting of product

*trimming and shaping of pieces may be required around openings as well as maintaining a level and coarsed pattern

Certain patterns are designed by Centurion to be laid with a mortar joint-like Rubble. For those patterns, the coverage area includes the mortar joint. For patterns designed to be drystacked-like Ledge, the coverage area does not include a mortar joint



DOOR BELL PLATE #815

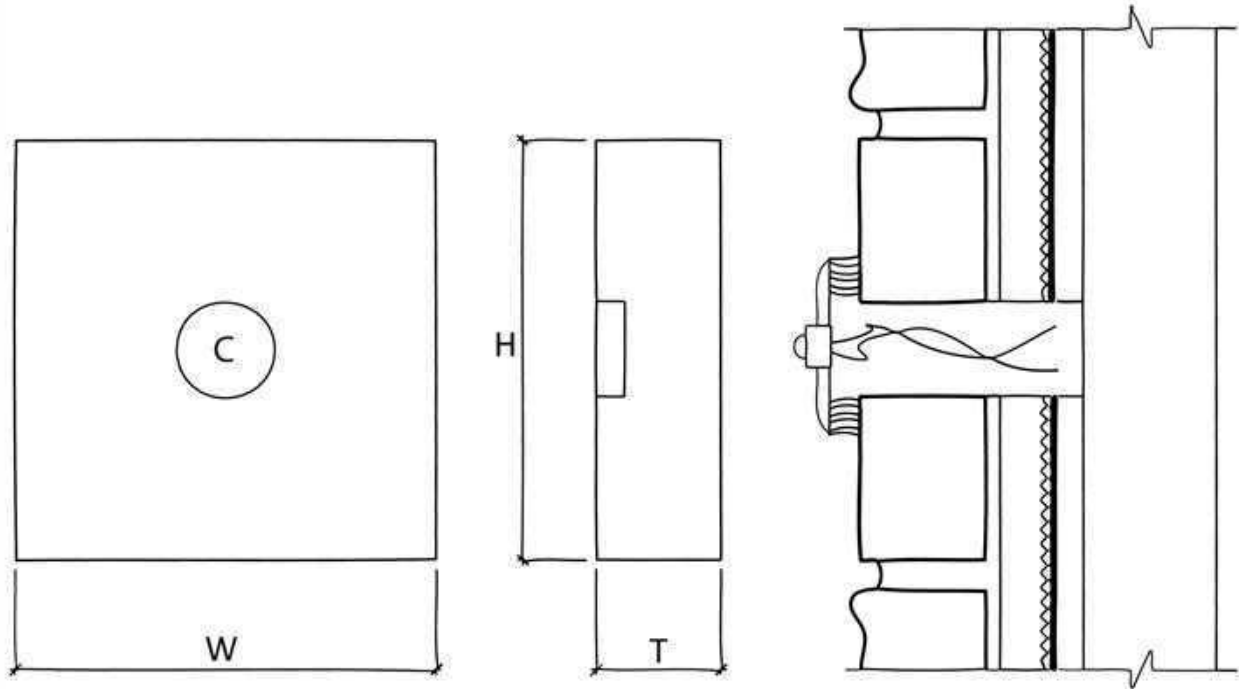

PATTERN DESCRIPTIONS AND DIMENSIONS

Pattern	Texture	Code	T	H	W	Cutout
DOOR BELL PLATE	Smooth face.	815	1"	4"	2 1/4"	DRILL

*thickness, height and width dimensions may have +/- tolerance due to hand casting of product

*trimming and shaping of pieces may be required around openings as well as maintaining a level and coarsed pattern

*Certain patterns are designed by Centurion to be laid with a mortar joint-like Rubble. For those patterns, the coverage area includes the mortar joint. For patterns designed to be drystack-like Ledge, the coverage area does not include a mortar joint

Packaging/Skid		Weights	
#	Pcs.	Skid	Pcs.
815	320	320	0.76

Standard Accessory Color Line	Color Code
APPALACHIA	250-25
BROWN	200-25
CHARDONAY	180-65
KENTUCKY	260-15
PENNSYLVANIA	800-25
MESA VALLEY	930-65
MISSOURI	100-15
PLAIN	330-20
SUEDE	185-65
TENNESSEE	010-15
TEXAS	310-10
TULSA	791-15



ELKMONT #460



Blend of:
Canyon Ledge, LedgeStone & Splitface

PATTERN DESCRIPTIONS AND DIMENSIONS

Pattern	Texture	Installation	T	H	W	Joint
ELKMONT	Square to rectangular stone with weathered face and random spotter pieces.	Installed level with spotter flat pieces.	1 1/4" to 2 1/4"	1" to 20"	5" to 21 3/4"	Drystack

Standard Color Line	Product Code	Recommended Accessory Color	Accessory Color Code
BROWNS VALLEY	460-145-65	CHARDONAY	180-65
KENTUCKY	460-260-15	KENTUCKY / TENNESSEE	260-15 / 010-15
PENNSYLVANIA	460-800-25	PENNSYLVANIA	800-25

*thickness, height and width dimensions may have +/- tolerance due to hand casting of product

*trimming and shaping of pieces may be required around openings as well as maintaining a level and coarsed pattern

*Certain patterns are designed by Centurion to be laid with a mortar joint-like Rubble. For those patterns, the coverage area includes the mortar joint. For patterns designed to be drystacked-like Ledge, the coverage area does not include a mortar joint

Packaging/Skid	Weights/Skid (Avg.)	
	Sq.Ft.	Lbs.
Flats	82	900
Corners	80	780



FIELDSTONE #020



PATTERN DESCRIPTIONS AND DIMENSIONS

Pattern	Texture	Installation	T	H	W	Joint
FIELDSTONE	Distinctively textured, smooth, rough faced flagstone look. Pieces are square, rectangular and angled.	Installed with the longest side down and level. A joint is required with pattern.	3/4" to 2"	4 3/4" to 18 3/4"	2" to 13 3/4"	3/4"

Standard Color Line	Product Code	Recommended Accessory Color	Accessory Color Code
BUCKS COUNTY	020-701-25	PENNSYLVANIA	800-25
KENTUCKY	020-260-15	KENTUCKY / TENNESSEE	260-15 / 010-15
PENNSYLVANIA	020-800-25	PENNSYLVANIA	800-25
PLAIN	020-330-20	PLAIN	330-20
TULSA	020-791-15	TULSA	791-15

*thickness, height and width dimensions may have +/- tolerance due to hand casting of product

*trimming and shaping of pieces may be required around openings as well as maintaining a level and coarsed pattern

*Certain patterns are designed by Centurion to be laid with a mortar joint-like Rubble. For those patterns, the coverage area includes the mortar joint. For patterns designed to be drystack-like Ledge, the coverage area does not include a mortar joint

Packaging/Skid	Weights/Skid (Avg.)	
	Sq.Ft.	Lbs.
Flats	92	819
Corners	96	866



FLAT COLUMN CAP #865, 869

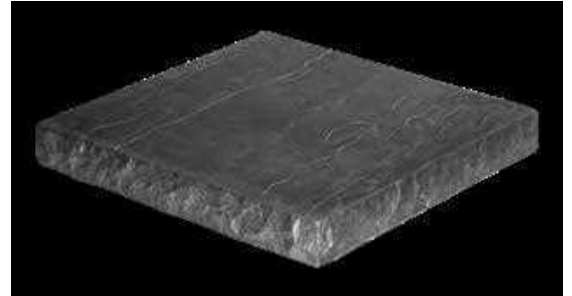
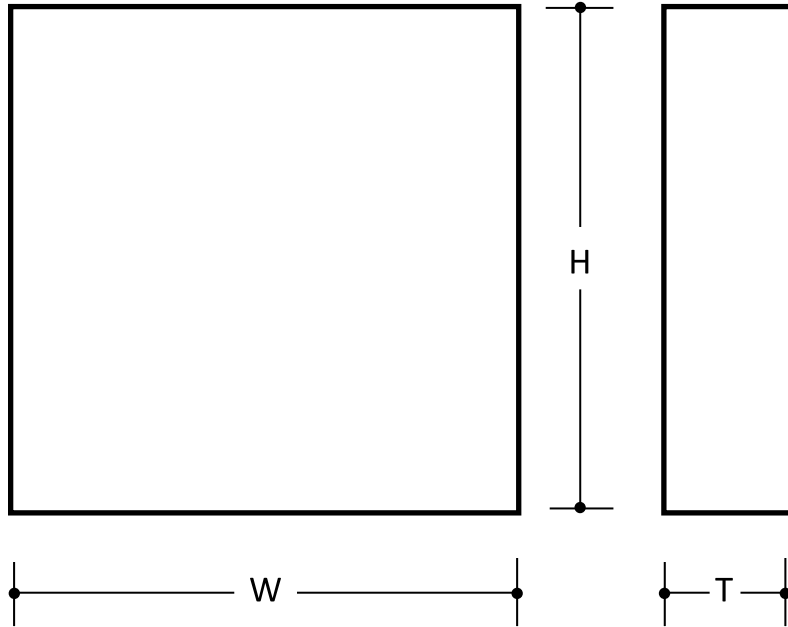

PATTERN DESCRIPTIONS AND DIMENSIONS

Pattern	Texture	Code	T	H	W
FLAT COLUMN CAP	Slate top with chiseled edges.	865	3"	24"	24"
FLAT COLUMN CAP	Slate top with chiseled edges.	869	3"	28"	28"

*thickness, height and width dimensions may have +/- tolerance due to hand casting of product

*trimming and shaping of pieces may be required around openings as well as maintaining a level and coarsed pattern

* Certain patterns are designed by Centurion to be laid with a mortar joint-like Rubble. For those patterns, the coverage area includes the mortar joint. For patterns designed to be drystack-like Ledge, the coverage area does not include a mortar joint

Packaging/Skid		Weights	
#	Pcs.	Skid	Pcs.
865	1-6	447	150
869	1-6	609	195

Standard Accessory Color Line	Color Code
APPALACHIA	250-25
BROWN	200-25
CHARDONAY	180-65
KENTUCKY	260-15
PENNSYLVANIA	800-25
MESA VALLEY	930-65
MISSOURI	100-15
PLAIN	330-20
SUEDE	185-65
TENNESSEE	010-15
TEXAS	310-10
TULSA	791-15



FLAT WALL CAPSTONE #555, 569

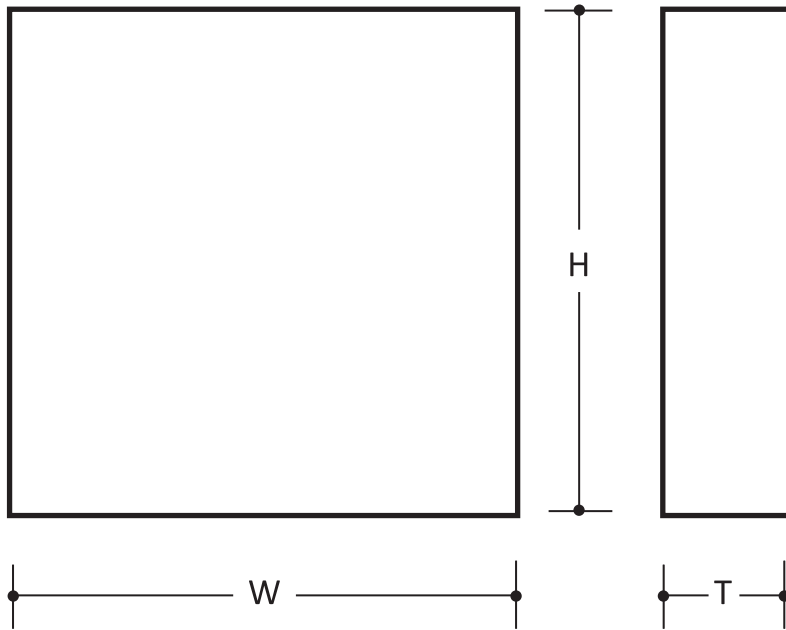

PATTERN DESCRIPTIONS AND DIMENSIONS

Pattern	Texture	Code	T	H	W
1 3/4" WALL CAPSTONE	Slate top chiseled edges.	555	1 3/4"	20"	12"
9 X 36 WALL CAPSTONE	Chiseled face.	569	2 3/4"	36"	9"

*thickness, height and width dimensions may have +/- tolerance due to hand casting of product

*trimming and shaping of pieces may be required around openings as well as maintaining a level and coarsed pattern

*Certain patterns are designed by Centurion to be laid with a mortar joint-like Rubble. For those patterns, the coverage area includes the mortar joint. For patterns designed to be drystack-like Ledge, the coverage area does not include a mortar joint

Packaging/Skid		Weights	
#	Pcs.	Skid	Pcs.
555	34	986	27
569	24	1586	58

Standard Accessory Color Line	Color Code
APPALACHIA	250-25
BROWN	200-25
CHARDONAY	180-65
KENTUCKY	260-15
PENNSYLVANIA	800-25
MESA VALLEY	930-65
MISSOURI	100-15
PLAIN	330-20
SUEDE	185-65
TENNESSEE	010-15
TEXAS	310-10
TULSA	791-15



FLINT RIDGE #430

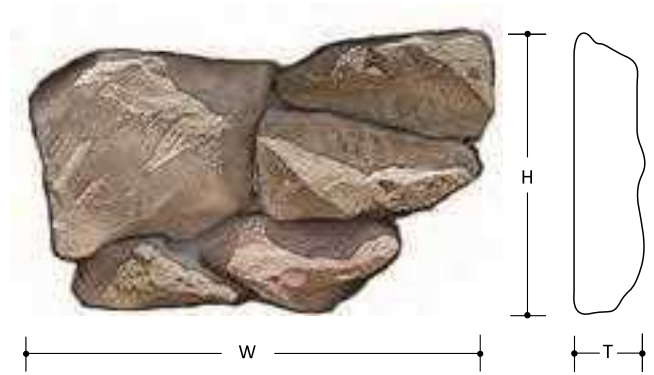

Blend of:
Fieldstone, Silhouette Ledge & Splitface

PATTERN DESCRIPTIONS AND DIMENSIONS

Pattern	Texture	Installation	T	H	W	Joint
FLINT RIDGE	Rugged textured from angular facets.	Installed at random. Mix small and large pieces for even blend.	3/4" To 2 1/2"	1 1/4" To 18 3/4"	2" to 21 3/4"	Drystack

* thickness, height and width dimensions may have +/- tolerance due to hand casting of product

* trimming and shaping of pieces may be required around openings as well as maintaining a level and coarsed pattern

* Certain patterns are designed by Centurion to be laid with a mortar joint-like Rubble. For those patterns, the coverage area includes the mortar joint. For patterns designed to be drystacked-like Ledge, the coverage area does not include a mortar joint

Standard Color Line	Product Code	Recommended Accessory Color	Accessory Color Code
BUCKS COUNTY	430-701-25	PENNSYLVANIA	800-25
KENTUCKY	430-260-15	KENTUCKY / TENNESSEE	260-15 / 010-15
MESA VALLEY	430-930-65	MESA VALLEY	930-65
PENNSYLVANIA	430-800-25	PENNSYLVANIA	800-25

Packaging/Skid		Weights/Skid (Avg.)
	Sq.Ft.	Lbs.
Flats	88	775
Corners	80	820



FOUNDATION STONE #530

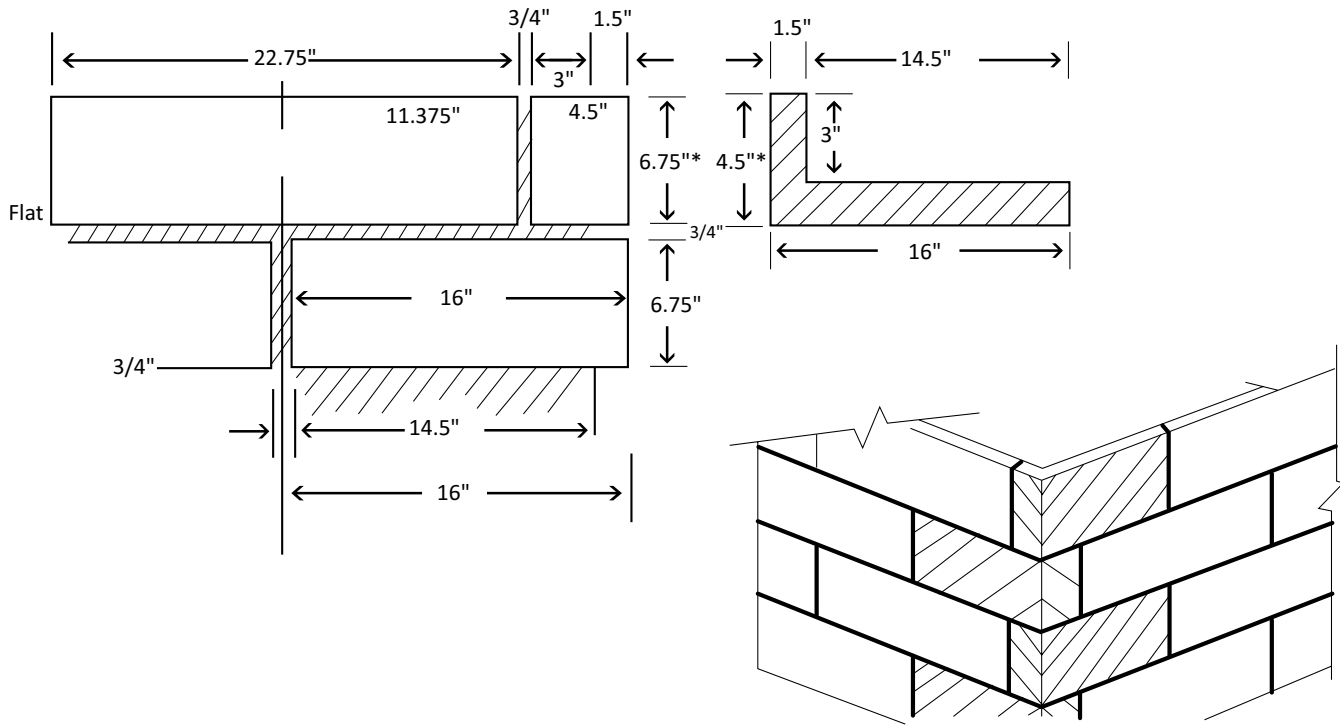

PATTERN DESCRIPTIONS AND DIMENSIONS

Pattern	Texture	T	H	W	Joint
Flat	Chiseled face	1.5"	6 3/4"	22 3/4"	3/4"
Corner		1.5"	6 3/4"	4 1/2" to 16"	

* thickness, height and width dimensions may have +/- tolerance due to hand casting of product

* trimming and shaping of pieces may be required around openings as well as maintaining a level and coarsed pattern

* Certain patterns are designed by Centurion to be laid with a mortar joint-like Rubble. For those patterns, the coverage area includes the mortar joint. For patterns designed to be drystack-like Ledge, the coverage area does not include a mortar joint

Standard Color Line*	Product Code	Recommended Accessory Color	Accessory Color Code
APPALACHIAN	530-250-15	APPALACHIAN	250-15
CRIMSON	530-578-25	CRIMSON	578-25
MILLWOOD	530-333-20	MILLWOOD	333-20
MISSOURI	530-100-15	MISSOURI	100-15
PLAIN	530-330-20	PLAIN	330-20
SAGE VALLEY	530-710-25	PENNSYLVANIA	800-25

*Foundation Stone colors are the majority base color similar to our accessories

	Packaging/Skid		Weights/Skid (Avg.)	
	Pcs	SqFt	Lbs.	
Flats	80	103.2	960	
Corners	64	42.8	435	



GEORGETOWN #440

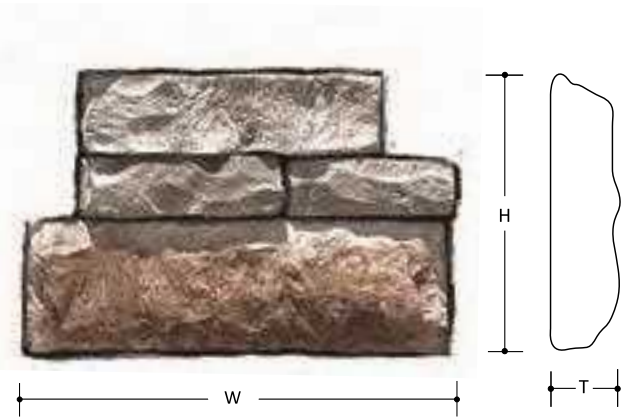

Blend of:
Cutface & Rubble

PATTERN DESCRIPTIONS AND DIMENSIONS

Pattern	Texture	Installation	T	H	W	Joint
GEORGETOWN	Square and rectangular design.	Installed in a random pattern with long side down.	1.5" to 3"	1" to 6"	4" to 20"	Drystack

*thickness, height and width dimensions may have +/- tolerance due to hand casting of product

*trimming and shaping of pieces may be required around openings as well as maintaining a level and coarsed pattern

*Certain patterns are designed by Centurion to be laid with a mortar joint-like Rubble. For those patterns, the coverage area includes the mortar joint. For patterns designed to be drystack-like Ledge, the coverage area does not include a mortar joint

Standard Color Line	Product Code	Recommended Accessory Color	Accessory Color Code
BUCKS COUNTY	440-701-25	PENNSYLVANIA	800-25
GRAY	440-030-45	GRAY	030-45
HERMITAGE	440-342-15	COASTAL	584-15
KENTUCKY	440-260-15	KENTUCKY / TENNESSEE	260-15 / 010-15
NORRIS GRAY	440-817-15	NORRIS GRAY	817-15
PENNSYLVANIA	440-800-25	PENNSYLVANIA	800-25
PLAIN	440-330-20	PLAIN	330-20
SMOKE	440-457-15	SMOKE	457-15
SUEDE	440-185-65	SUEDE / MESA VALLEY	185-65 / 930-65
TULSA	440-791-15	TULSA	791-15

Packaging/Skid	Weights/Skid (Avg.)	
	Sq.Ft.	Lbs.
Flats	96	920
Corners	80	840



HACKETT #050



PATTERN DESCRIPTIONS AND DIMENSIONS

Pattern	Texture	Installation	T	H	W	Joint
HACKETT	Unique one of a kind pattern. Old pieces from farm fences with years of weathering.	Installed horizontally and level. May have a roll in plane to resemble old farm fences.	1.5" to 2.5"	2" to 4"	4" to 14"	Drystack

* thickness, height and width dimensions may have +/- tolerance due to hand casting of product

* trimming and shaping of pieces may be required around openings as well as maintaining a level and coarsed pattern

* Certain patterns are designed by Centurion to be laid with a mortar joint-like Rubble. For those patterns, the coverage area includes the mortar joint. For patterns designed to be drystacked-like Ledge, the coverage area does not include a mortar joint

Standard Color Line	Product Code	Recommended Accessory Color	Accessory Color Code
BUCKS COUNTY	050-701-25	PENNSYLVANIA	800-25
ENGLISH	050-270-15	APPALACHIAN	250-15
TULSA	050-791-15	TULSA	791-15

Packaging/Skid	Weights/Skid (Avg.)	
	Sq.Ft.	Lbs.
Flats	88	900
Corners	72	700



HEARTHSTONE #860

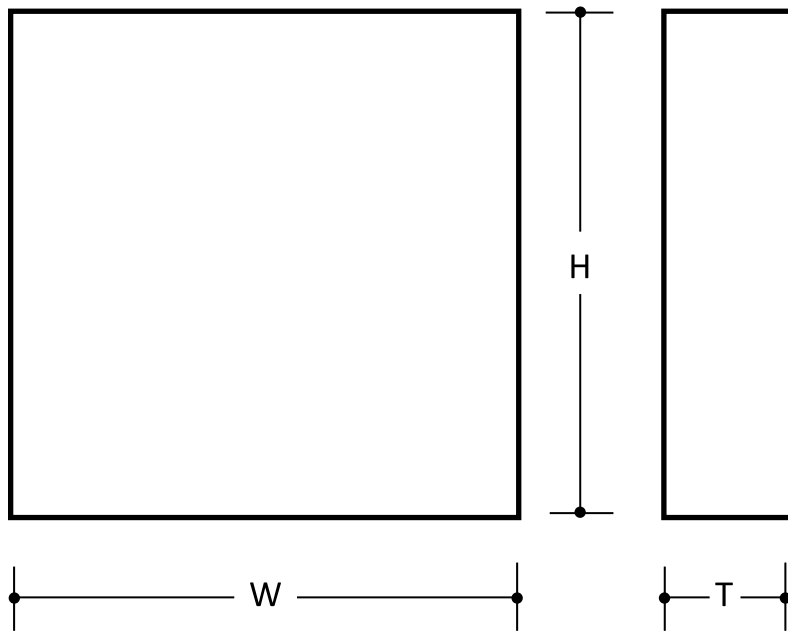

PATTERN DESCRIPTIONS AND DIMENSIONS

Pattern	Texture	Code	T	H	W
HEARTHSTONE	Flat slate top with chiseled edges.	860	1.75"	20"	18"

*thickness, height and width dimensions may have +/- tolerance due to hand casting of product

*trimming and shaping of pieces may be required around openings as well as maintaining a level and coarsed pattern

*Certain patterns are designed by Centurion to be laid with a mortar joint-like Rubble. For those patterns, the coverage area includes the mortar joint. For patterns designed to be drystack-like Ledge, the coverage area does not include a mortar joint

Packaging/Skid		Weights	
#	Pcs.	Skid	Pcs.
860	34	1326	37



Standard Accessory Color Line	Color Code
APPALACHIA	250-25
BROWN	200-25
CHARDONAY	180-65
KENTUCKY	260-15
PENNSYLVANIA	800-25
MESA VALLEY	930-65
MISSOURI	100-15
PLAIN	330-20
SUEDE	185-65
TENNESSEE	010-15
TEXAS	310-10
TULSA	791-15

KEYSTONES #880, 634

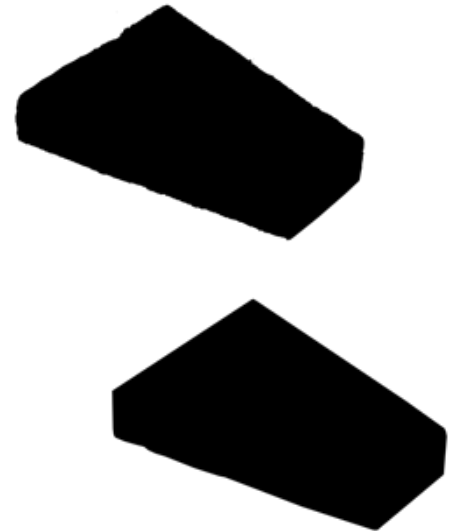
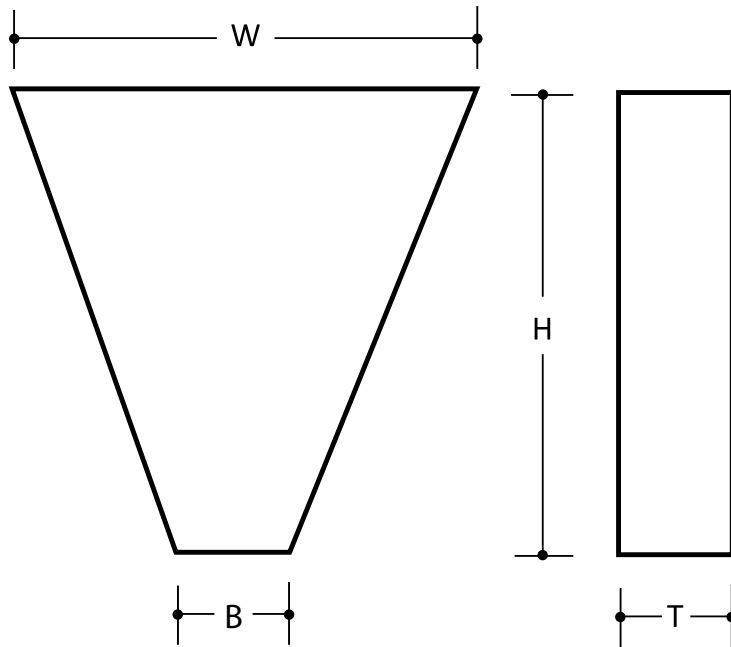

PATTERN DESCRIPTIONS AND DIMENSIONS

Pattern	Texture	Code	T	H	W	Bottom Width
KEYSTONE	Chiseled face	634	2"	10.25"	7.75"	4"
KEYSTONE	Slate face	880	2"	10.75"	8"	4"

*thickness, height and width dimensions may have +/- tolerance due to hand casting of product

*trimming and shaping of pieces may be required around openings as well as maintaining a level and coarsed pattern

*Certain patterns are designed by Centurion to be laid with a mortar joint-like Rubble. For those patterns, the coverage area includes the mortar joint. For patterns designed to be drystack-like Ledge, the coverage area does not include a mortar joint

#	Packaging		Weights		
	Pcs./Skid	Pcs/Box	Skid	Box	Pcs.
634	60	4	480	35	6.8
880	60	4	540	35	7.7

Standard Accessory Color Line	Color Code
APPALACHIA	250-25
BROWN	200-25
CHARDONAY	180-65
KENTUCKY	260-15
PENNSYLVANIA	800-25
MESA VALLEY	930-65
MISSOURI	100-15
PLAIN	330-20
SUEDE	185-65
TENNESSEE	010-15
TEXAS	310-10
TULSA	791-15



LEDGESTONE #150



- *thickness, height and width dimensions may have +/- tolerance due to hand casting of product
- *trimming and shaping of pieces may be required around openings as well as maintaining a level and coarsed pattern
- *Certain patterns are designed by Centurion to be laid with a mortar joint-like Rubble. For those patterns, the coverage area includes the mortar joint. For patterns designed to be drystack-like Ledge, the coverage area does not include a mortar joint

PATTERN DESCRIPTIONS AND DIMENSIONS

Pattern	Texture	Installation	T	H	W	Rec Joint
LEDGE	Look of split layered stone. Long dimensional pieces. Narrow style gives edges a pronounced look.	Installed in a stacked design with no joint. Stack as tight as possible.	1/2" to 2 3/4"	1" to 3"	6 3/4" to 16 3/4"	DRystack

Standard Color Line	Product Code	Recommended Accessory Color	Accessory Color Code
APPALACHIAN	150-250-15	APPALACHIAN	250-15
BROWN	150-200-25	BROWN	200-25
BUCKS COUNTY	150-701-25	PENNSYLVANIA	800-25
COASTAL	150-584-15	COASTAL	584-15
GRAY	150-030-45	GRAY	030-45
HERMITAGE	150-342-15	COASTAL	584-15
KENTUCKY	150-260-15	KENTUCKY / TENNESSEE	260-150 / 010-15
LOUISVILLE	150-262-15	KENTUCKY / TENNESSEE	260-15 / 010-15
NORRIS GRAY	150-817-15	NORRIS GRAY	817-15
PENNSYLVANIA	150-800-25	PENNSYLVANIA	800-25
MT. RUNDLE NO ACCENT	150-492-70	MT. RUNDLE	490-70
SUEDE	150-185-65	MESA VALLEY / SUEDE	930-65 / 185-65
TEXAS	150-310-10	TEXAS	310-10

Packaging/Skid	Weights/Skid (Avg.)	
	Sq.Ft.	Lbs.
Flats	88	920
Corners	72	600



MESA #420



Blend of:
Ledgestone, Palos Verde & Stack

PATTERN DESCRIPTIONS AND DIMENSIONS

Pattern	Texture	Installation	Thickness	Height	Width	Rec Joint
MESA	Square and rectangular pieces with flat spotter pieces.	Installed at random with long sides down and level. Spot in flat pieces at random.	1.5" to 3"	2" to 12"	4" to 18"	DRystack

*thickness, height and width dimensions may have +/- tolerance due to hand casting of product

*trimming and shaping of pieces may be required around openings as well as maintaining a level and coarsed pattern

*Certain patterns are designed by Centurion to be laid with a mortar joint-like Rubble. For those patterns, the coverage area includes the mortar joint. For patterns designed to be drystack-like Ledge, the coverage area does not include a mortar joint

Standard Color Line	Product Code	Recommended Accessory Color	Accessory Color Code
APPALACHIAN	420-250-15	APPALACHIAN	250-15
BUCKS COUNTY	420-701-25	PENNSYLVANIA	800-25
MT RUNDLE NO ACCENT	420-492-70	MT RUNDLE	490-70
PENNSYLVANIA	420-800-25	PENNSYLVANIA	800-25

Packaging/Skid	Weights/Skid (Avg.)	
	Sq.Ft.	Lbs.
Flats	90	870
Corners	80	600



MILANO #485

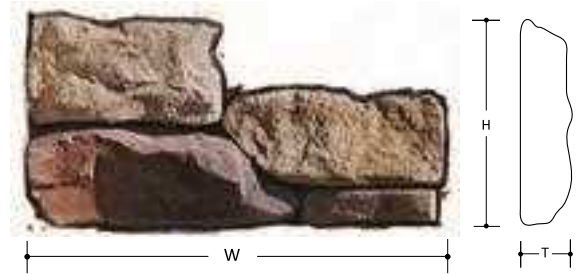

Blend of:
Hackett, LedgeStone, Silhouette Ledge
& Weatheredge

PATTERN DESCRIPTIONS AND DIMENSIONS

Pattern	Texture	Installation	Thickness	Height	Width	Rec Joint
MILANO	Quarried look, rough chiseled pieces.	Lay at random design.	1.5" to 2.5"	2" to 6"	4" to 18"	DRystack

*thickness, height and width dimensions may have +/- tolerance due to hand casting of product

*trimming and shaping of pieces may be required around openings as well as maintaining a level and coarsed pattern

*Certain patterns are designed by Centurion to be laid with a mortar joint-like Rubble. For those patterns, the coverage area includes the mortar joint. For patterns designed to be drystack-like Ledge, the coverage area does not include a mortar joint

Standard Color Line	Product Code	Recommended Accessory Color	Accessory Color Code
BUCKS COUNTY	485-701-25	PENNSYLVANIA	800-25
KENTUCKY	485-260-15	KENTUCKY / TENNESSEE	260-15 / 010-15
PENNSYLVANIA	485-800-25	PENNSYLVANIA	800-25
SUEDE	485-185-65	SUEDE / MESA VALLEY	185-65 / 930-65

Packaging/Skid	Weights/Skid (Avg.)	
	Sq.Ft.	Skid
Flats	93	900
Corners	80	850



MOUNTAIN LEDGE #210



PATTERN DESCRIPTIONS AND DIMENSIONS

Pattern	Texture	Code	Thickness	Height	Width	Rec Joint
FLAT	Rugged distinct pieces of mountain ledge. Panels are designed for easy installation.	210	3/4" to 1 1/2"	4"	8" to 12"	DRystack
CORNER			3/4" to 1 1/2"	4"	8"	

*thickness, height and width dimensions may have +/- tolerance due to hand casting of product

*trimming and shaping of pieces may be required around openings as well as maintaining a level and coarsed pattern

*Certain patterns are designed by Centurion to be laid with a mortar joint-like Rubble. For those patterns, the coverage area includes the mortar joint. For patterns designed to be drystack-like Ledge, the coverage area does not include a mortar joint

Standard Color Line	Product Code	Recommended Accessory Color	Accessory Color Code
AUSTIN	210-647-10	TEXAS	310-10
BUCKS COUNTY	210-701-25	PENNSYLVANIA	800-25
KENTUCKY	210-260-15	KENTUCKY / TENNESSEE	260-15 / 010-15
OXFORD	210-469-20	OXFORD	469-20

Packaging/Skid		Weights/Skid (Avg.)
Flats	88.88	875
Corners	72	700



OHIO LIMESTONE # 190



PATTERN DESCRIPTIONS AND DIMENSIONS

Pattern	Texture	Installation	Thickness	Height	Width	Joint
OHIO LIMESTONE	Semi-coursed pattern with a "chopped" face for a natural and more contemporary appearance.	A coarsed looking pattern yet no set pattern design. Installed level and plumb.	1" to 1 3/4"	1 3/4" to 8 1/2"	5" to 17 1/2"	3/4"

* thickness, height and width dimensions may have +/- tolerance due to hand casting of product

* trimming and shaping of pieces may be required around openings as well as maintaining a level and coarsed pattern

* Certain patterns are designed by Centurion to be laid with a mortar joint-like Rubble. For those patterns, the coverage area includes the mortar joint. For patterns designed to be drystack-like Ledge, the coverage area does not include a mortar joint

Standard Color Line	Product Code	Recommended Accessory Color	Accessory Color Code
BROWNS VALLEY	190-145-65	CHARDONAY	180-65
DOVE	190-031-45	GRAY	030-45
LOUISVILLE	190-262-15	KENTUCKY / TENNESSEE	260-15 / 010-15
MILLWOOD	190-333-20	MILLWOOD	333-20
PLAIN	190-330-20	PLAIN	330-20
TULSA	190-791-15	TULSA	791-15

	Packaging	Weights (Avg)	
	Sq.Ft.	Lbs.	
Flats	108	1035	
Corners	96	920	



OMAHA #475



Blend of:
Ashlar, Rubble & Weatheredge

PATTERN DESCRIPTIONS AND DIMENSIONS

Pattern	Texture	Installation	T	H	W	Joint
OMAHA	Quarried look, rough chiseled pieces.	Lay at random design.	1.5" to 2.5"	2" to 6"	4" to 18"	Drystack

*thickness, height and width dimensions may have +/- tolerance due to hand casting of product

*trimming and shaping of pieces may be required around openings as well as maintaining a level and coarsed pattern

*Certain patterns are designed by Centurion to be laid with a mortar joint-like Rubble. For those patterns, the coverage area includes the mortar joint. For patterns designed to be drystacked-like Ledge, the coverage area does not include a mortar joint

Standard Color Line	Product Code	Recommended Accessory Color	Accessory Color Code
BROWNS VALLEY	475-145-65	CHARDONAY	180-65
BUCKS COUNTY	475-701-25	PENNSYLVANIA	800-25
PENNSYLVANIA	475-800-25	PENNSYLVANIA	800-25
PLAIN	475-330-20	PLAIN	330-20
TULSA	475-791-15	TULSA	791-15

Packaging/Skid	Weights/Skid (Avg)	
	Sq.Ft.	Lbs.
Flats	99	975
Corners	80	950



OUTLET BOX TRIM #886, 888

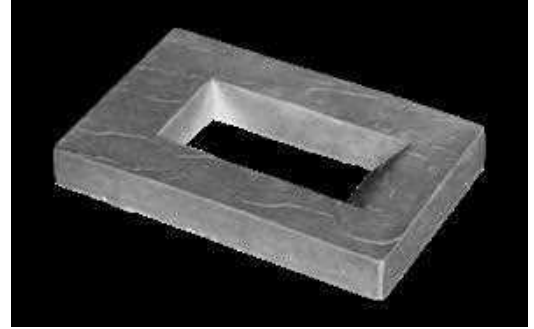
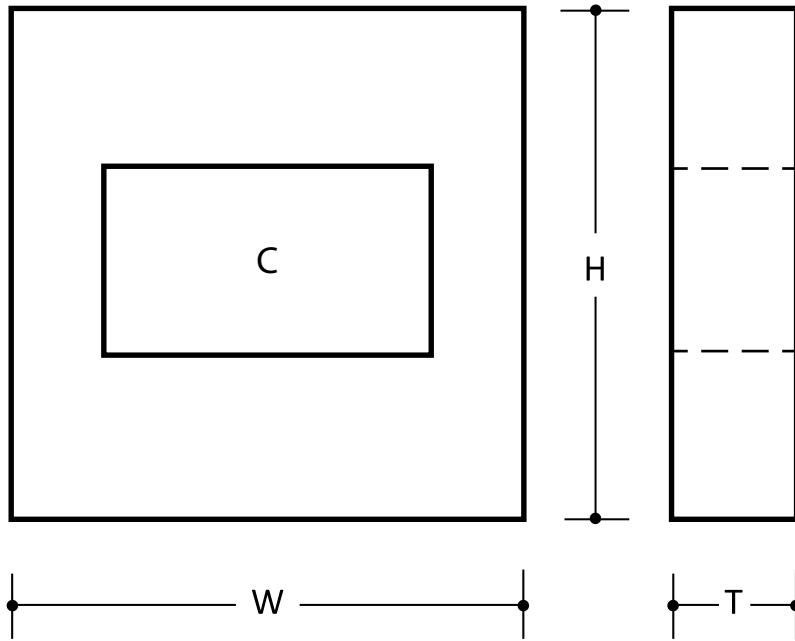

PATTERN DESCRIPTIONS AND DIMENSIONS

Pattern	Texture	Code	T	H	W	Cutout
OUTLET BOX TRIM	Slate face	886	1.5"	6.75"	7.75"	2.25" x 4.25"
OUTLET BOX TRIM		888	1.5"	12"	8"	3.5" x 6.5"

*thickness, height and width dimensions may have +/- tolerance due to hand casting of product

*trimming and shaping of pieces may be required around openings as well as maintaining a level and coarsed pattern

*Certain patterns are designed by Centurion to be laid with a mortar joint-like Rubble. For those patterns, the coverage area includes the mortar joint. For patterns designed to be drystack-like Ledge, the coverage area does not include a mortar joint

Standard Accessory Color Line	Color Code
APPALACHIA	250-25
BROWN	200-25
CHARDONAY	180-65
KENTUCKY	260-15
PENNSYLVANIA	800-25
MESA VALLEY	930-65
MISSOURI	100-15
PLAIN	330-20
SUEDE	185-65
TENNESSEE	010-15
TEXAS	310-10
TULSA	791-15

#	Packaging		Weights		
	Pcs./Skid	Pcs/Box	Skid	Box	Pcs.
886	120	8	480	40	3.4
888	120	4	480	18	3.4



PALOS VERDE #040

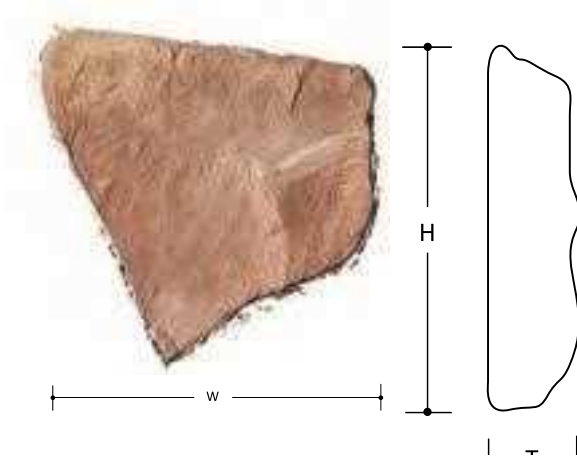

PATTERN DESCRIPTIONS AND DIMENSIONS

Pattern	Texture	Installation	T	H	W	Joint
PALOS VERDE	Large stone pattern. Quarried look with split flagstone texture.	Randomly installed with even sized joints.	1" to 2"	1 3/4" to 13 1/2"	5" to 20 1/2"	3/4"

* thickness, height and width dimensions may have +/- tolerance due to hand casting of product

* trimming and shaping of pieces may be required around openings as well as maintaining a level and coarsed pattern

* Certain patterns are designed by Centurion to be laid with a mortar joint-like Rubble. For those patterns, the coverage area includes the mortar joint. For patterns designed to be drystack-like Ledge, the coverage area does not include a mortar joint

Standard Color Line	Product Code	Recommended Accessory Color	Accessory Color Code
BUCKS COUNTY	040-701-25	PENNSYLVANIA	800-25
KENTUCKY	040-260-15	KENTUCKY / TENNESSEE	260-15 / 010-15
PENNSYLVANIA	040-800-25	PENNSYLVANIA	800-25

Packaging/Skid	Weights/Skid (Avg)	
	Sq.Ft.	Lbs.
Flats	108	890
Corners	96	975



PLANTATION #295

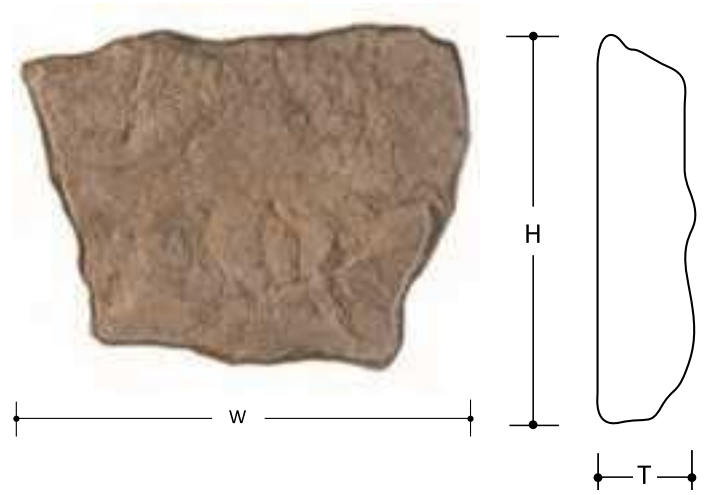

PATTERN DESCRIPTIONS AND DIMENSIONS

Pattern	Texture	T	H	W	Joint
FLAT	Large individual pieces designed to be installed at random with a wide mortar joint.	1" to 2"	1 3/4" to 13"	4" to 21"	3/4"

*thickness, height and width dimensions may have +/- tolerance due to hand casting of product

*trimming and shaping of pieces may be required around openings as well as maintaining a level and coarsed pattern

*Certain patterns are designed by Centurion to be laid with a mortar joint-like Rubble. For those patterns, the coverage area includes the mortar joint. For patterns designed to be drystack-like Ledge, the coverage area does not include a mortar joint

Standard Color Line	Product Code	Recommended Accessory Color	Accessory Color Code
BUCKS COUNTY	295-701-25	PENNSYLVANIA	800-25
LOUISVILLE	295-262-15	KENTUCKY / TENNESSEE	260-15 / 010-15
OXFORD	295-469-20	OXFORD	469-20
PENNSYLVANIA	295-800-25	PENNSYLVANIA	800-25
TULSA	295-791-15	TULSA	791-15

Packaging/Skid	Weights/Skid (Avg)	
	Sq.Ft.	Lbs.
Flats	108	890
Corners	96	820



Quarry Stone #255

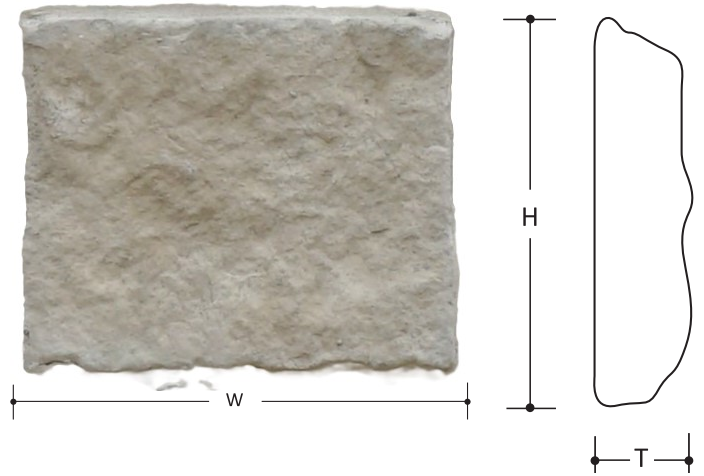

PATTERN DESCRIPTIONS AND DIMENSIONS

Pattern	Texture	T	H	W	Joint
FLAT	Quarry cut textured pieces designed to be installed Semi-Coarsed with a standard mortar joint.	3/4" to 1 1/2"	1 3/4" to 11"	6" to 20"	3/4"

*thickness, height and width dimensions may have +/- tolerance due to hand casting of product

*trimming and shaping of pieces may be required around openings as well as maintaining a level and coarsed pattern

*Certain patterns are designed by Centurion to be laid with a mortar joint-like Rubble. For those patterns, the coverage area includes the mortar joint. For patterns designed to be drystack-like Ledge, the coverage area does not include a mortar joint

Standard Color Line	Product Code	Recommended Accessory Color	Accessory Color Code
BUCKS COUNTY	255-701-25	PENNSYLVANIA	800-25
LOUISVILLE	255-262-15	KENTUCKY / TENNESSEE	260-15 / 010-15
IVORY BUFF	255-516-19	IVORY BUFF	516-19
BELL HARBOUR	255-634-18	BELL HARBOUR	634-18
TULSA	255-791-15	TULSA	791-15

Packaging/Skid	Weights/Skid (Avg)	
	Sq.Ft.	Lbs.
Flats	120	925
Corners	100	725



QUOIN CORNERS #301

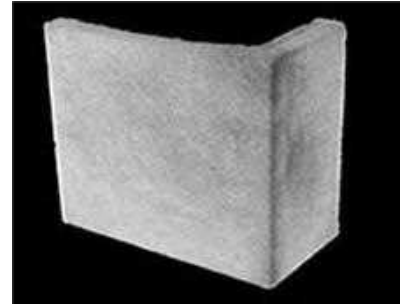
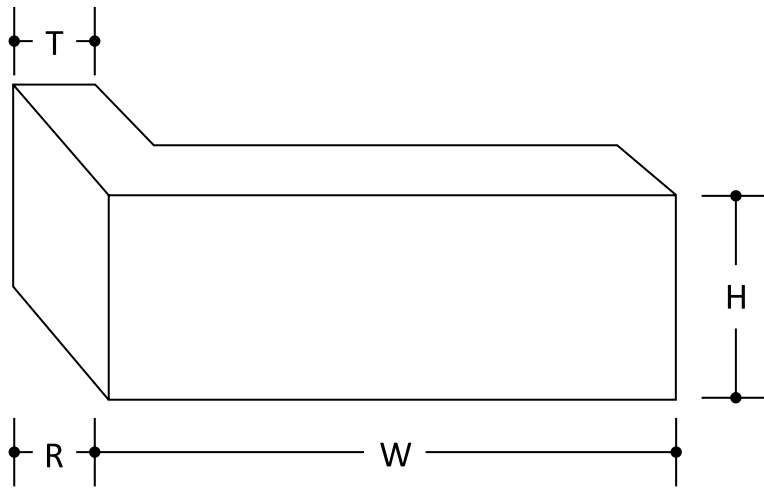

PATTERN DESCRIPTIONS AND DIMENSIONS

Pattern	Texture	Code	T	H	W	Face
QUOIN CORNERS	Smooth Face	301	1.5"	12"	14"	6.75"

*thickness, height and width dimensions may have +/- tolerance due to hand casting of product

*trimming and shaping of pieces may be required around openings as well as maintaining a level and coarsed pattern

*Certain patterns are designed by Centurion to be laid with a mortar joint-like Rubble. For those patterns, the coverage area includes the mortar joint. For patterns designed to be drystack-like Ledge, the coverage area does not include a mortar joint

Standard Accessory Color Line	Color Code
APPALACHIA	250-25
BROWN	200-25
CHARDONAY	180-65
KENTUCKY	260-15
PENNSYLVANIA	800-25
MESA VALLEY	930-65
MISSOURI	100-15
PLAIN	330-20
SUEDE	185-65
TENNESSEE	010-15
TEXAS	310-10
TULSA	791-15

Packaging/Skid		Weights	
#	Pcs.	Skid	Pcs
301	32	960	27.6



QUOIN FLATS #302, 303

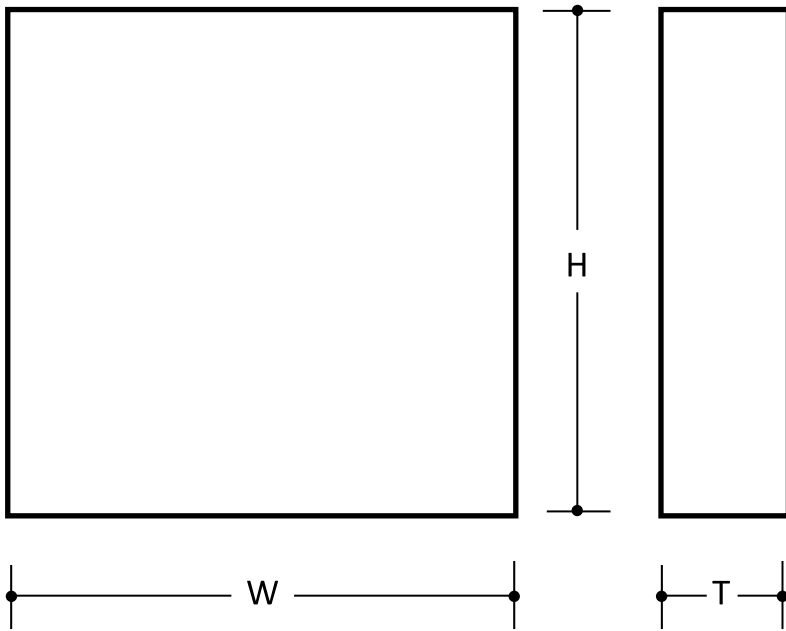

PATTERN DESCRIPTIONS AND DIMENSIONS

Pattern	Texture	Code	T	H	W
QUOIN FLATS	Smooth Face	302	1 3/4"	14"	7"
		303	1 1/2"	14"	12"

*thickness, height and width dimensions may have +/- tolerance due to hand casting of product

*trimming and shaping of pieces may be required around openings as well as maintaining a level and coarsed pattern

*Certain patterns are designed by Centurion to be laid with a mortar joint-like Rubble. For those patterns, the coverage area includes the mortar joint. For patterns designed to be drystack-like Ledge, the coverage area does not include a mortar joint

Standard Accessory Color Line	Color Code
APPALACHIA	250-25
BROWN	200-25
CHARDONAY	180-65
KENTUCKY	260-15
PENNSYLVANIA	800-25
MESA VALLEY	930-65
MISSOURI	100-15
PLAIN	330-20
SUEDE	185-65
TENNESSEE	010-15
TEXAS	310-10
TULSA	791-15

Packaging/Skid		Weights	
#	Pcs.	Skid	Pcs
302	120	1800	14
303	112	1568	13



RETRO SILL #597

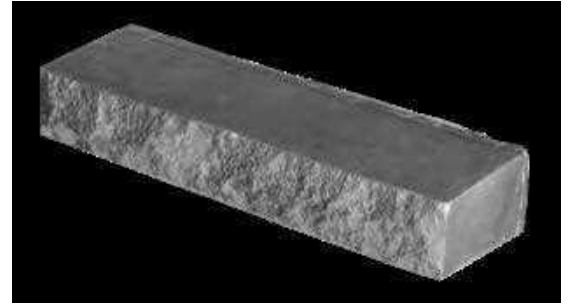
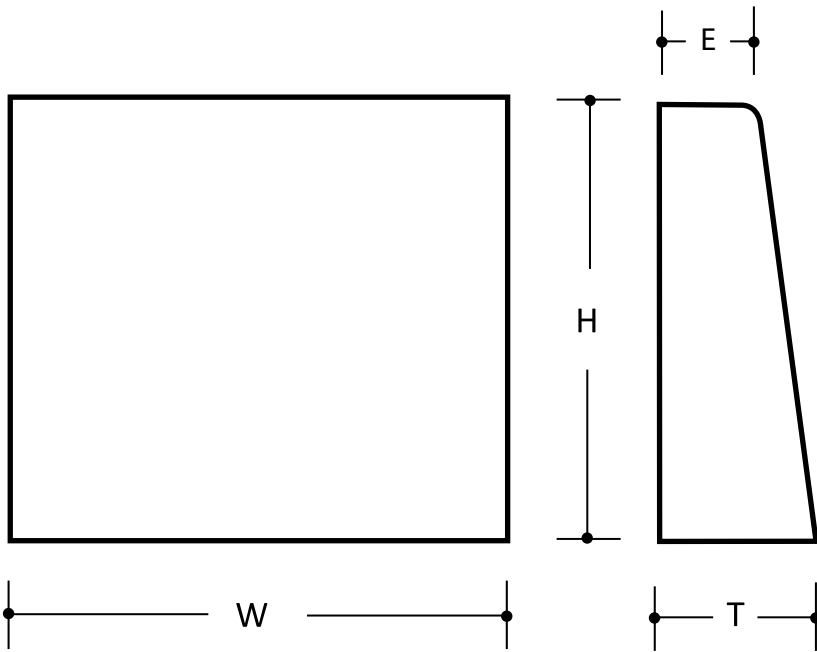

PATTERN DESCRIPTIONS AND DIMENSIONS

Pattern	Texture	Code	T	H	W	Edge
RETRO SILL	Chiseled face and edges.	597	4"	6.75"	24"	3.5"

*thickness, height and width dimensions may have +/- tolerance due to hand casting of product

*trimming and shaping of pieces may be required around openings as well as maintaining a level and coarsed pattern

*Certain patterns are designed by Centurion to be laid with a mortar joint-like Rubble. For those patterns, the coverage area includes the mortar joint. For patterns designed to be drystack-like Ledge, the coverage area does not include a mortar joint

Standard Accessory Color Line	Color Code
APPALACHIA	250-25
BROWN	200-25
CHARDONAY	180-65
KENTUCKY	260-15
PENNSYLVANIA	800-25
MESA VALLEY	930-65
MISSOURI	100-15
PLAIN	330-20
SUEDE	185-65
TENNESSEE	010-15
TEXAS	310-10
TULSA	791-15

Packaging/Skid		Weights	
#	Pcs.	Skid	Pcs.
597	39	2142	49



RIVER ROCK #080

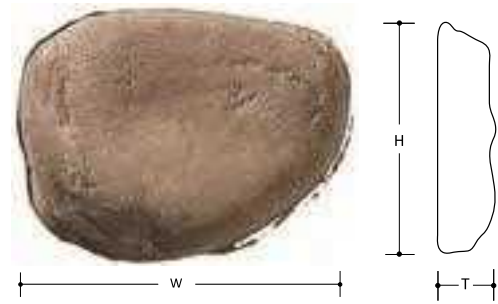

PATTERN DESCRIPTIONS AND DIMENSIONS

Pattern	Texture	Installation	T	H	W	Joint
RIVER ROCK	Round and oval oblong pieces. Texture from years of water running over them.	Installed randomly with radises coming together to form even looking mortar joints.	1.25" to 2.5"	4" to 15"	4" to 15"	3/4"

* thickness, height and width dimensions may have +/- tolerance due to hand casting of product

* trimming and shaping of pieces may be required around openings as well as maintaining a level and coarsed pattern

* Certain patterns are designed by Centurion to be laid with a mortar joint-like Rubble. For those patterns, the coverage area includes the mortar joint. For patterns designed to be drystack-like Ledge, the coverage area does not include a mortar joint

Standard Color Line	Product Code	Recommended Accessory Color	Accessory Color Code
DESERT RUST	080-360-25	CALIFORNIA	220-25
EARTH BLEND	080-280-35	CALIFORNIA	220-25
VALLEY BROOK	080-719-25	CALIFORNIA BASE MIX ONLY	223-25

Packaging/Skid	Weights/Skid (Avg)	
	Sq.Ft.	Lbs.
Flats	96	970
Corners	88	835



ROCK FACE SILL #878

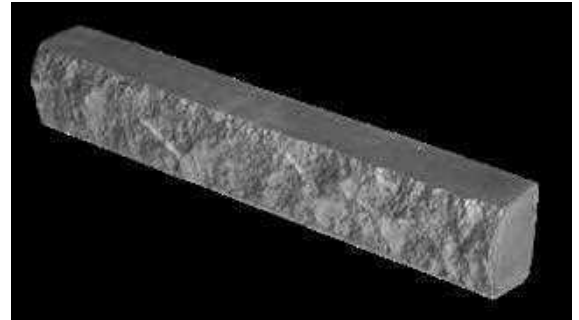
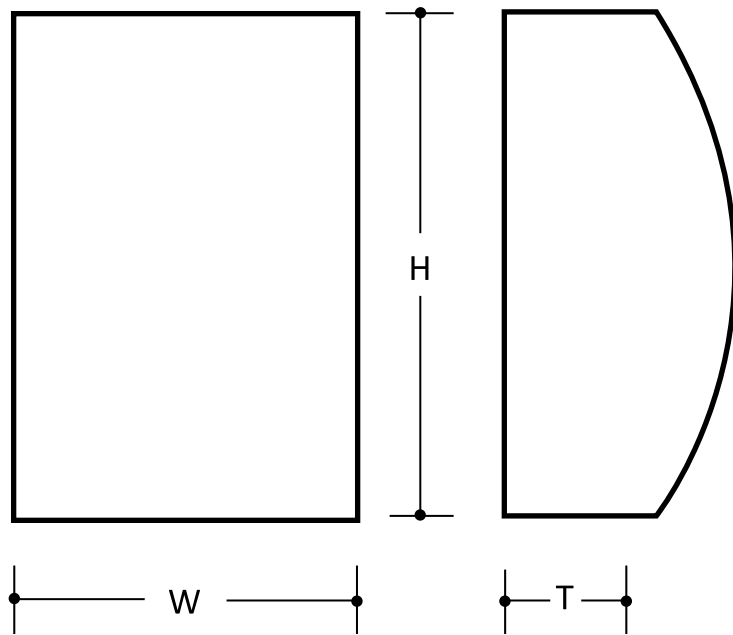

PATTERN DESCRIPTIONS AND DIMENSIONS

Pattern	Texture	Code	T	H	W
ROCK FACE SILL	Chiseled face and edges.	878	2.5"	3.5"	24"

*thickness, height and width dimensions may have +/- tolerance due to hand casting of product

*trimming and shaping of pieces may be required around openings as well as maintaining a level and coarsed pattern

*Certain patterns are designed by Centurion to be laid with a mortar joint-like Rubble. For those patterns, the coverage area includes the mortar joint. For patterns designed to be drystack-like Ledge, the coverage area does not include a mortar joint

Standard Accessory Color Line	Color Code
APPALACHIA	250-25
BROWN	200-25
CHARDONAY	180-65
KENTUCKY	260-15
PENNSYLVANIA	800-25
MESA VALLEY	930-65
MISSOURI	100-15
PLAIN	330-20
SUEDE	185-65
TENNESSEE	010-15
TEXAS	310-10
TULSA	791-15

Packaging/Skid		Weights	
#	Pcs.	Skid	Pcs.
878	42	630	13.2



RUBBLE #250



*thickness, height and width dimensions may have +/- tolerance due to hand casting of product
 *trimming and shaping of pieces may be required around openings as well as maintaining a level and coarsed pattern
 *Certain patterns are designed by Centurion to be laid with a mortar joint-like Rubble. For those patterns, the coverage area includes the mortar joint. For patterns designed to be drystack-like Ledge, the coverage area does not include a mortar joint

PATTERN DESCRIPTIONS AND DIMENSIONS

Pattern	Texture	Installation	T	H	W	Joint
RUBBLE	A hand dressed tailored look. Pieces roughly squared and face chiseled.	A coarsed looking pattern yet no set pattern design. Installed level and plumb.	1 1/4" to 2 1/2"	2 1/2" to 8 3/4"	4 3/4" to 20"	3/4"

Standard Color Line	Product Code	Recommended Accessory Color	Accessory Color Code
BUCKS COUNTY	250-701-25	PENNSYLVANIA	800-25
GRAY	250-030-45	GRAY	030-45
HERMITAGE	250-342-15	COASTAL	584-15
KENTUCKY	250-262-15	KENTUCKY / TENNESSEE	260-15 / 010-15
MESA VALLEY	250-930-65	MESA VALLEY	930-65
PENNSYLVANIA	250-800-25	PENNSYLVANIA	800-25
PLAIN	250-330-20	PLAIN	330-20
SUEDE	250-185-65	MESA VALLEY / SUEDE	930-65 / 185-65
TEXAS	250-310-10	TEXAS	310-10
TULSA	250-791-15	TULSA	791-15

Packaging/Skid	Weights/Skid (Avg)	
	Sq.Ft.	Lbs.
Flats	112	940
Corners	96	850



RUBBLE WINDOW STONE #610

#612

#613

#615

#616

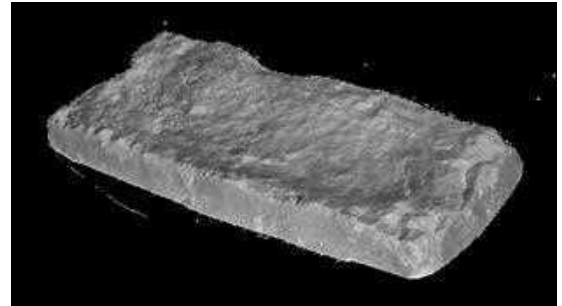
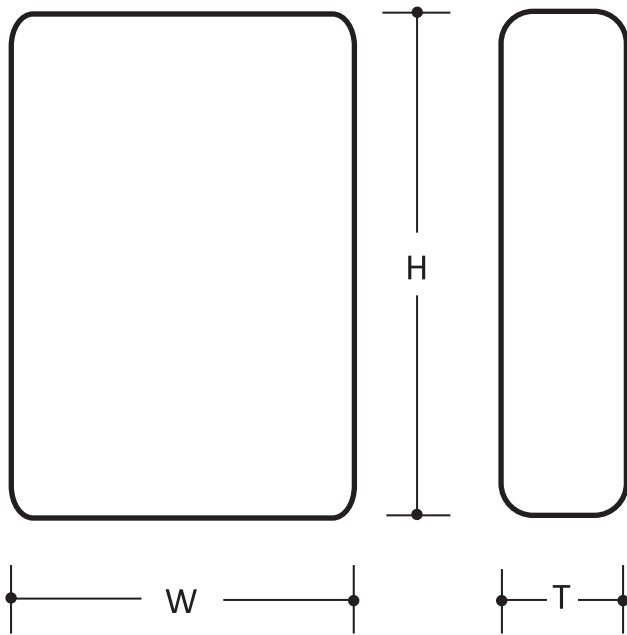

PATTERN DESCRIPTIONS AND DIMENSIONS

Pattern	Texture	Code	T	H	W
RUBBLE WINDOW STONES	Raised face and edges.	610	1.25"	5.5"	11.5"
		615	1.25"	4.5"	5.5"
		616	1.25"	5"	8"
	Right tilted.	612	1.25"	5"	7.5"
	Left tilted.	613	1.25"	5"	7.5"

Standard Accessory Color Line	Color Code
APPALACHIA	250-25
BROWN	200-25
CHARDONAY	180-65
KENTUCKY	260-15
PENNSYLVANIA	800-25
MESA VALLEY	930-65
MISSOURI	100-15
PLAIN	330-20
SUEDE	185-65
TENNESSEE	010-15
TEXAS	310-10
TULSA	791-15

Packaging/Skid		Weights	
#	Pcs.	Skid	Pcs.
610	240	720	2.7
615	480	1195	2.5
616	240	720	2.7
612	240	720	2.7
613	240	720	2.7

*thickness, height and width dimensions may have +/- tolerance due to hand casting of product

*trimming and shaping of pieces may be required around openings as well as maintaining a level and coarsed pattern

*Certain patterns are designed by Centurion to be laid with a mortar joint-like Rubble. For those patterns, the coverage area includes the mortar joint. For patterns designed to be drystack-like Ledge, the coverage area does not include a mortar joint



RUSTIC #900

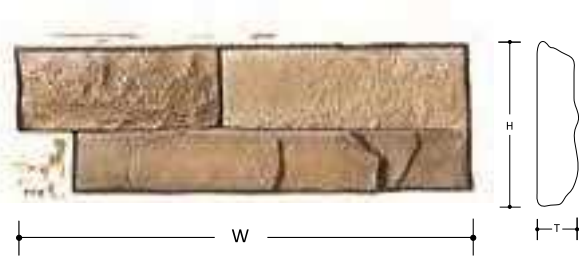

Blend of:
Stack & Rubble

PATTERN DESCRIPTIONS AND DIMENSIONS

Pattern	Texture	Installation	T	H	W	Rec Joint
RUSTIC	Predominately square; rectangular design.	Install with long side down and level.	1.5" to 2.5"	2" to 6"	4" to 20"	DRystack

*thickness, height and width dimensions may have +/- tolerance due to hand casting of product

*trimming and shaping of pieces may be required around openings as well as maintaining a level and coarsed pattern

*Certain patterns are designed by Centurion to be laid with a mortar joint-like Rubble. For those patterns, the coverage area includes the mortar joint. For patterns designed to be drystack-like Ledge, the coverage area does not include a mortar joint

Standard Color Line	Product Code	Recommended Accessory Color	Accessory Color Code
ARIZONA	900-724-25	BROWN	200-25
BROWN	900-200-25	BROWN	200-25
BUCKS COUNTY	900-701-25	PENNSYLVANIA	800-25
GRAY	900-030-45	GRAY	030-45
HERMITAGE	900-342-15	COASTAL	584-15
LOUISVILLE	900-262-15	KENTUCKY / TENNESSEE	260-15 / 010-15
KENTUCKY	900-260-15	KENTUCKY / TENNESSEE	260-15 / 010-15
PENNSYLVANIA	900-800-25	PENNSYLVANIA	800-25
PLAIN	900-330-20	PLAIN	330-20
SUEDE	900-185-65	MESA VALLEY / SUEDE	930-65 / 185-65

	Packaging/Skid	Weights/Skid (Avg)
	Sq.Ft.	Lbs.
Flats	94	915
Corners	80	700



SHUTTER STRIP #810

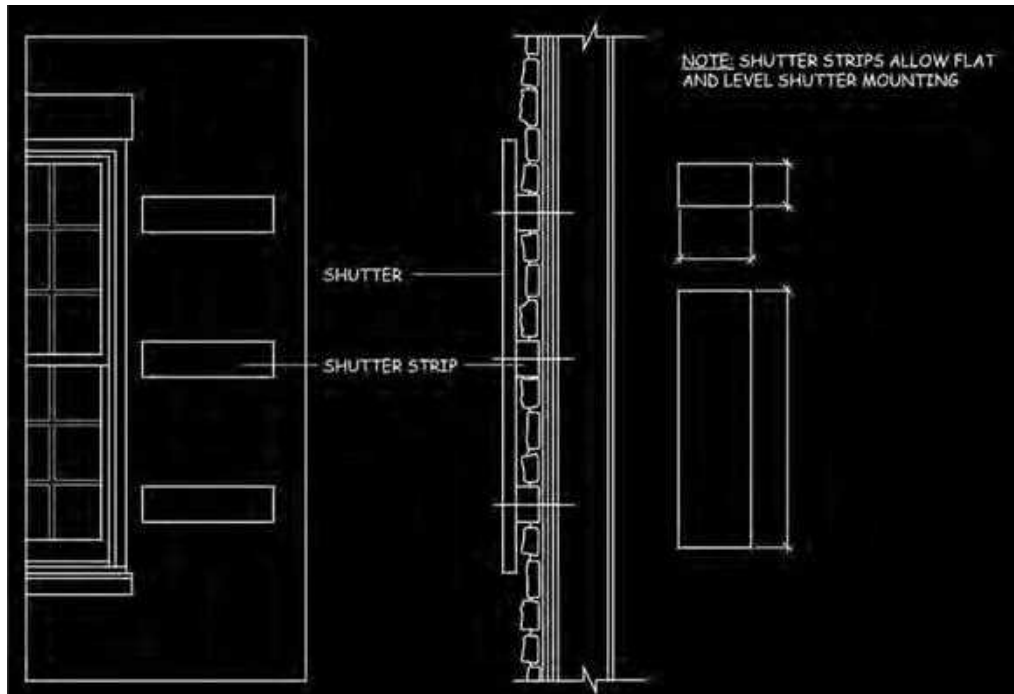

PATTERN DESCRIPTIONS AND DIMENSIONS

Pattern	Texture	Code	T	H	W
SHUTTER STRIP	Square cut edges, smooth face.	810	2"	4"	14.25"

*thickness, height and width dimensions may have +/- tolerance due to hand casting of product

*trimming and shaping of pieces may be required around openings as well as maintaining a level and coarsed pattern

*Certain patterns are designed by Centurion to be laid with a mortar joint-like Rubble. For those patterns, the coverage area includes the mortar joint. For patterns designed to be drystack-like Ledge, the coverage area does not include a mortar joint

Standard Accessory Color Line	Color Code
APPALACHIA	250-25
BROWN	200-25
CHARDONAY	180-65
KENTUCKY	260-15
PENNSYLVANIA	800-25
MESA VALLEY	930-65
MISSOURI	100-15
PLAIN	330-20
SUEDE	185-65
TENNESSEE	010-15
TEXAS	310-10
TULSA	791-15

Packaging/Skid		Weights	
#	Pcs.	Skid	Pcs.
810	126	756	5.4



SILHOUETTE LEDGE #160



PATTERN DESCRIPTIONS AND DIMENSIONS

Pattern	Texture	Installation	T	H	W	Joint
SILHOUETTE LEDGE	Rugged textured from angular facets.	Installed at random with even sized mortar joints.	1/2" to 2 3/4"	1 1/4" to 5 1/2"	4 1/2" to 19"	3/4"

* thickness, height and width dimensions may have +/- tolerance due to hand casting of product

* trimming and shaping of pieces may be required around openings as well as maintaining a level and coarsed pattern

* Certain patterns are designed by Centurion to be laid with a mortar joint-like Rubble. For those patterns, the coverage area includes the mortar joint. For patterns designed to be drystack-like Ledge, the coverage area does not include a mortar joint

Standard Color Line	Product Code	Recommended Accessory Color	Accessory Color Code
BUCKS COUNTY	160-701-25	PENNSYLVANIA	800-25
CATALINA	160-690-25	PENNSYLVANIA	800-25
PENNSYLVANIA	160-800-25	PENNSYLVANIA	800-25
PLAIN	160-330-20	PLAIN	330-20
SUEDE	160-185-65	MESA VALLEY / SUEDE	930-65 / 185-65

Packaging/Skid	Weights/Skid (Avg)	
	Sq.Ft.	Lbs.
Flats	100	770
Corners	72	830



SPLIT FLAT COLUMN CAP #866

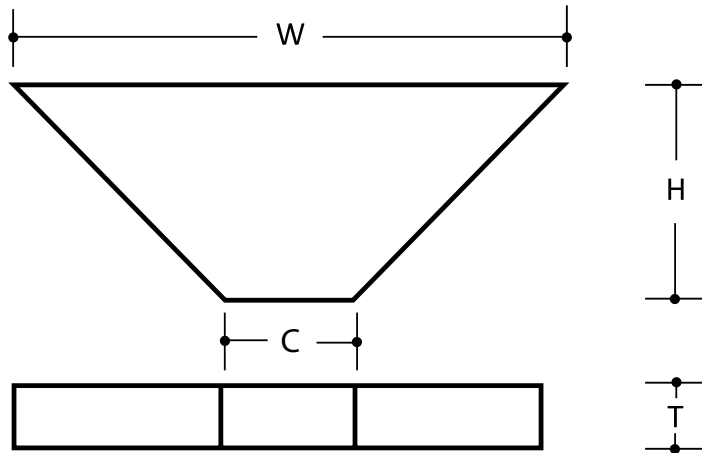

4 pieces per set and sold by the set

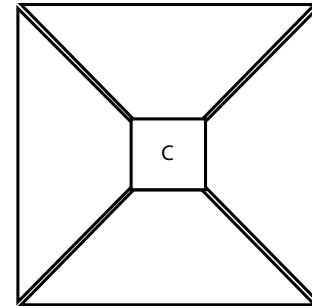

PATTERN DESCRIPTIONS AND DIMENSIONS

Pattern	Texture	Code	T	H	W	Cutout
SPLIT FLAT COLUMN CAP	Slate top. Chiseled edges.	866	4.25"	11.5"	28"	7"

*thickness, height and width dimensions may have +/- tolerance due to hand casting of product

*trimming and shaping of pieces may be required around openings as well as maintaining a level and coarsed pattern

*Certain patterns are designed by Centurion to be laid with a mortar joint-like Rubble. For those patterns, the coverage area includes the mortar joint. For patterns designed to be drystack-like Ledge, the coverage area does not include a mortar joint

Standard Accessory Color Line	Color Code
APPALACHIA	250-25
BROWN	200-25
CHARDONAY	180-65
KENTUCKY	260-15
PENNSYLVANIA	800-25
MESA VALLEY	930-65
MISSOURI	100-15
PLAIN	330-20
SUEDE	185-65
TENNESSEE	010-15
TEXAS	310-10
TULSA	791-15

Packaging/Skid		Weights	
#	Pcs.	Skid	Pcs.
866	20 (5 sets)	1140	57 lbs ea (228 lbs per set)



SPLITFACE #200

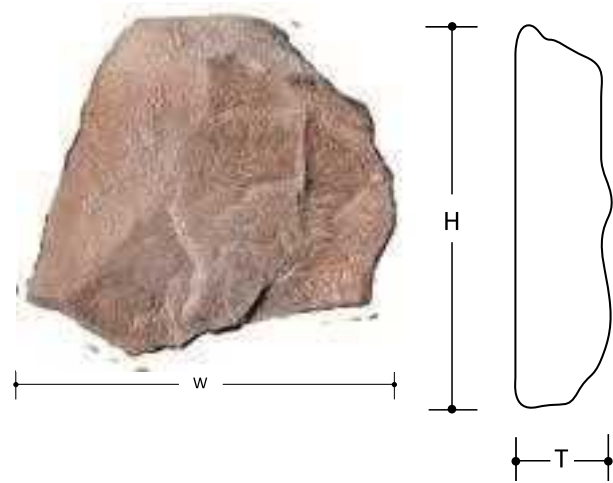

PATTERN DESCRIPTIONS AND DIMENSIONS

Pattern	Texture	Installation	T	H	W	Rec Joint
SPLITFACE	A split hand dressed stone. Extraordinary depth is from angular facets of varying sizes.	Installed at random with even sized mortar joints.	3/4" to 1 1/2"	2 3/4" to 13"	4" to 16 3/4"	3/4"

*thickness, height and width dimensions may have +/- tolerance due to hand casting of product

*trimming and shaping of pieces may be required around openings as well as maintaining a level and coarsed pattern

*Certain patterns are designed by Centurion to be laid with a mortar joint-like Rubble. For those patterns, the coverage area includes the mortar joint. For patterns designed to be drystack-like Ledge, the coverage area does not include a mortar joint

Standard Color Line	Product Code	Recommended Accessory Color	Accessory Color Code
BUCKS COUNTY	200-701-25	PENNSYLVANIA	800-25
ENGLISH	200-270-15	APPALACHIAN	250-15
NEW ENGLAND	200-290-15	APPALACHIAN	250-15
PENNSYLVANIA	200-800-25	PENNSYLVANIA	800-25
PLAIN	200-330-20	PLAIN	330-20

Packaging/Skid	Weights/Skid (Avg)	
	Sq.Ft.	Lbs.
Flats	92	955
Corners	88	750



STACK #100

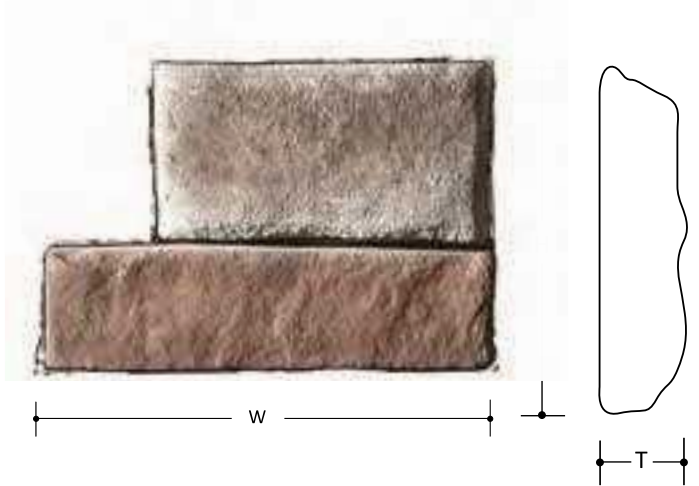

PATTERN DESCRIPTIONS AND DIMENSIONS

Pattern	Texture	Installation	T	H	W	Joint
STACK	Texture from smooth to gillotine cut.	Installed on a horizontal plane with no pieces on a vertical plane. A tight fitted pattern when drystacked. Mortar joint is acceptable.	1" to 2 1/4"	1" to 4"	3 1/2" to 18"	Drystack

*thickness, height and width dimensions may have +/- tolerance due to hand casting of product

*trimming and shaping of pieces may be required around openings as well as maintaining a level and coarsed pattern

*Certain patterns are designed by Centurion to be laid with a mortar joint-like Rubble. For those patterns, the coverage area includes the mortar joint. For patterns designed to be drystacked-like Ledge, the coverage area does not include a mortar joint

Standard Color Line	Product Code	Recommended Accessory Color	Accessory Color Code
BROWNS VALLEY	100-145-65	CHARDONAY	180-65
BUCKS COUNTY	100-701-25	PENNSYLVANIA	800-25
COASTAL	100-584-15	COASTAL	584-15
GRAY	100-030-45	GRAY	030-45
KENTUCKY	100-260-15	KENTUCKY / TENNESSEE	260-15 / 010-15
NORRIS GRAY	100-817-15	NORRIS GRAY	817-15
OXFORD	100-469-20	OXFORD	469-20
PENNSYLVANIA	100-800-25	PENNSYLVANIA	800-25
PLAIN	100-330-20	PLAIN	330-20
SUEDE	100-185-65	MESA VALLEY / SUEDE	930-65 / 185-65

Packaging/Skid	Weights/Skid (Avg)	
	Sq.Ft.	Lbs.
Flats	88	950
Corners	72	585



Topeka #175



*thickness, height and width dimensions may have +/- tolerance due to hand casting of product
 *trimming and shaping of pieces may be required around openings as well as maintaining a level and coarsed pattern
 *Certain patterns are designed by Centurion to be laid with a mortar joint-like Rubble. For those patterns, the coverage area includes the mortar joint. For patterns designed to be drystack-like Ledge, the coverage area does not include a mortar joint

PATTERN DESCRIPTIONS AND DIMENSIONS

Pattern	Texture	Installation	T	H	W	Joint
Topeka	This pattern was designed to showcase the Split or Satin finish of natural stone	This Pattern is designed to be laid in a random pattern with a 3/4" joint	3/4" to 1 3/4"	3 3/4" to 22"	2" to 12"	3/4"

Standard Color Line	Product Code	Recommended Accessory Color	Accessory Color Code
BUCKS COUNTY	250-701-25	PENNSYLVANIA	800-25
Harpeth	250-476-47	Harpeth	476-47
HERMITAGE	250-342-15	COASTAL	584-15
KENTUCKY	250-262-15	KENTUCKY / TENNESSEE	260-15 / 010-15
LoneStar	250-623-25	Lonestar	623-25
PENNSYLVANIA	250-800-25	PENNSYLVANIA	800-25
PLAIN	250-330-20	PLAIN	330-20
Santos	250-673-18	Santos	673-18
TEXAS	250-310-10	TEXAS	310-10
TULSA	250-791-15	TULSA	791-15

Packaging/Skid	Weights/Skid (Avg)	
	Sq.Ft.	Lbs.
Flats	112	850
Corners	96	800



TRIM STONE #611

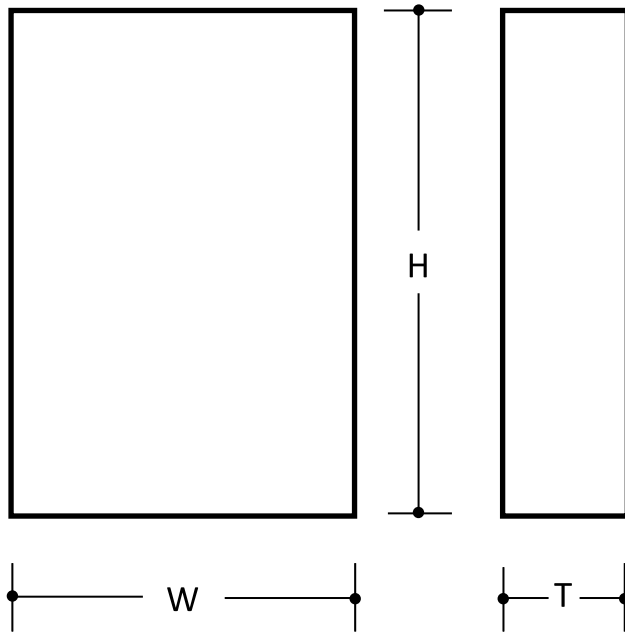

PATTERN DESCRIPTIONS AND DIMENSIONS

Pattern	Texture	Code	T	H	W
TRIM STONE	Square cut edges. Slate face.	611	2"	6"	8"

*thickness, height and width dimensions may have +/- tolerance due to hand casting of product

*trimming and shaping of pieces may be required around openings as well as maintaining a level and coarsed pattern

*Certain patterns are designed by Centurion to be laid with a mortar joint-like Rubble. For those patterns, the coverage area includes the mortar joint. For patterns designed to be drystack-like Ledge, the coverage area does not include a mortar joint

Standard Accessory Color Line	Color Code
APPALACHIA	250-25
BROWN	200-25
CHARDONAY	180-65
KENTUCKY	260-15
PENNSYLVANIA	800-25
MESA VALLEY	930-65
MISSOURI	100-15
PLAIN	330-20
SUEDE	185-65
TENNESSEE	010-15
TEXAS	310-10
TULSA	791-15

Packaging/Skid		Weights	
#	Pcs.	Skid	Pcs.
611	108	648	5.3



VINE HILL #410

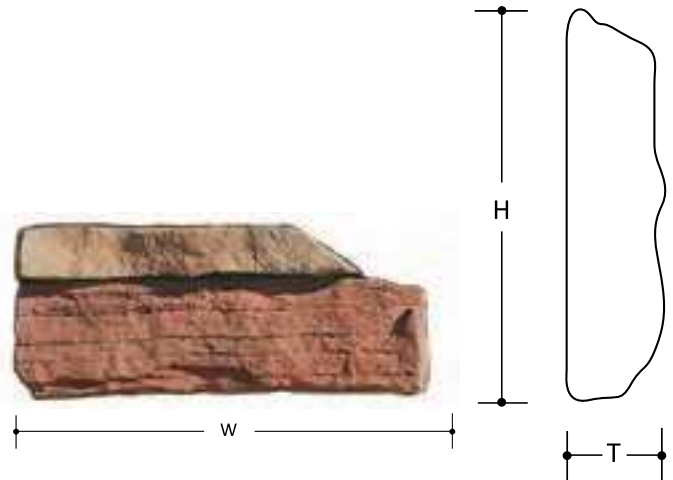

Blend of:
Palos Verde & Weatheredge

PATTERN DESCRIPTIONS AND DIMENSIONS

Pattern	Texture	Installation	T	H	W	Rec Joint
VINE HILL	Predominately square and rectangular with irregular spotter pieces.	Installed on a level pattern with long side down. Spotter pieces randomly placed.	1.5" to 3"	2.25" to 12"	4" to 23"	DRystack

*thickness, height and width dimensions may have +/- tolerance due to hand casting of product

*trimming and shaping of pieces may be required around openings as well as maintaining a level and coarsed pattern

*Certain patterns are designed by Centurion to be laid with a mortar joint-like Rubble. For those patterns, the coverage area includes the mortar joint. For patterns designed to be drystack-like Ledge, the coverage area does not include a mortar joint

Standard Color Line	Product Code	Recommended Accessory Color	Accessory Color Code
GRAY	410-030-45	GRAY	030-45
LOUISVILLE	410-262-15	KENTUCKY / TENNESSEE	260-15 / 010-15
PENNSYLVANIA	410-800-25	PENNSYLVANIA	800-25
SUEDE	410-185-65	MESA VALLEY / SUEDE	930-65 / 185-65

	Packaging/Skid	Weights/Skid (Avg)	
	Sq.Ft.	Lbs.	
Flats	102	1000	
Corners	80	865	



WATER BIB TRIM #890

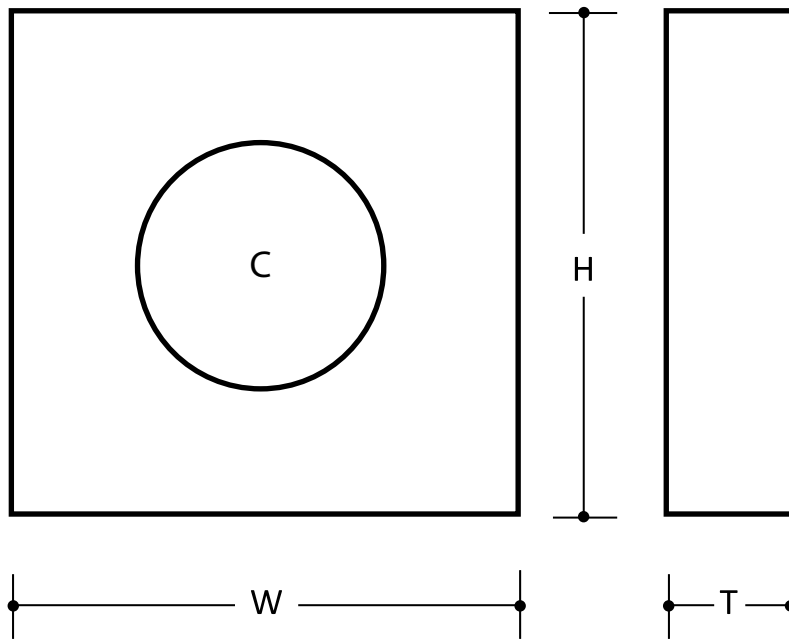

PATTERN DESCRIPTIONS AND DIMENSIONS

Pattern	Texture	Code	T	H	W	Cutout
WATER BIB TRIM	Slate face.	890	1.5"	6.75"	7.75"	1.5"

*thickness, height and width dimensions may have +/- tolerance due to hand casting of product

*trimming and shaping of pieces may be required around openings as well as maintaining a level and coarsed pattern

*Certain patterns are designed by Centurion to be laid with a mortar joint-like Rubble. For those patterns, the coverage area includes the mortar joint. For patterns designed to be drystack-like Ledge, the coverage area does not include a mortar joint

Standard Accessory Color Line	Color Code
APPALACHIA	250-25
BROWN	200-25
CHARDONAY	180-65
KENTUCKY	260-15
PENNSYLVANIA	800-25
MESA VALLEY	930-65
MISSOURI	100-15
PLAIN	330-20
SUEDE	185-65
TENNESSEE	010-15
TEXAS	310-10
TULSA	791-15

#	Packaging		Weights		
	Pcs./Skid	Pcs/Box	Skid	Box	Pcs.
890	120	8	720	43	5.4



WEATHEREDGE #260



PATTERN DESCRIPTIONS AND DIMENSIONS

Pattern	Texture	Installation	T	H	W	Joint
WEATHEREDGE	The look of weathering erosion highlights the edges of this pattern.	Installed on horizontal level plane with mortar joint. No stones to be laid in vertical or angled position.	1" to 2 1/2"	1" to 7"	6 1/2" to 23"	3/4"

*thickness, height and width dimensions may have +/- tolerance due to hand casting of product

*trimming and shaping of pieces may be required around openings as well as maintaining a level and coarsed pattern

*Certain patterns are designed by Centurion to be laid with a mortar joint-like Rubble. For those patterns, the coverage area includes the mortar joint. For patterns designed to be drystack-like Ledge, the coverage area does not include a mortar joint

Standard Color Line	Product Code	Recommended Accessory Color	Accessory Color Code
BUCKS COUNTY	260-701-25	PENNSYLVANIA	800-25
KENTUCKY	260-260-15	KENTUCKY / TENNESSEE	260-15 / 010-15
MESA VALLEY	260-930-65	MESA VALLEY / SUEDE	930-65 / 185-65
PENNSYLVANIA	260-800-25	PENNSYLVANIA	800-25
TULSA	260-791-15	TULSA	791-15

Packaging/Skid	Weights/Skid (Avg)	
	Sq.Ft.	Lbs.
Flats	116	1075
Corners	80	1070

