

MORTAR BED
 STONE VENEER
 MORTAR JOINT
 (WHERE USED)

SHUTTER
 SHUTTER STRIP
 ALLOWS FOR A FLAT
 AND LEVEL SHUTTER
 MOUNTING

STUD WALL
 EXT. SHEATHING
 MOISTURE BARRIER
 (2 LAYERS)

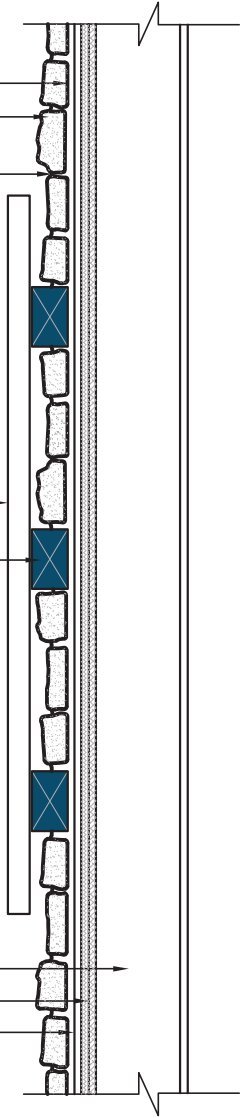

SPECIFICATIONS:

APPLIED: PER CENTURION STONE VENEER
 INSTALLATION PROCEDURES REFERENCE
 ICC ES REPORT ESR-2239 FOR SPECIFIC CODE
 REQUIREMENTS

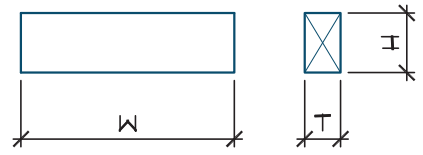

SHUTTER STRIP:

PATTERN - SHUTTER STRIP
 TEXTURE - SMOOTH FACE
 CODE - P810
 THICKNESS - 2"
 HEIGHT - 4"
 WIDTH - 14"

PACKAGING:

PIECES - 126
 WEIGHT - BOX - 950LBS
 WEIGHT - PIECE - 7LBS

NOT TO SCALE



Centurion Products, LLC.
 7201 Cockrill Bend Blvd
 Nashville, TN 37209
 www.CenturionStone.com

SHUTTER STRIP

K5