

COACH LIGHT TRIM P 885/P887

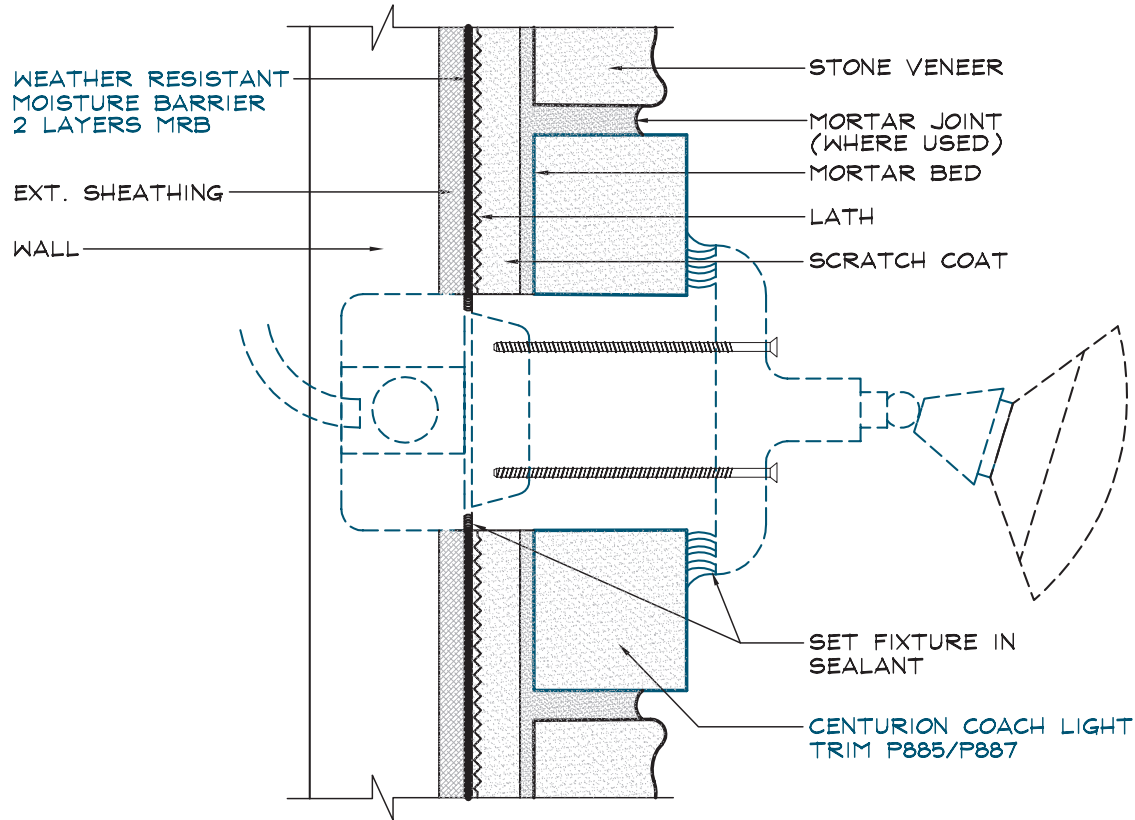

SPECIFICATIONS:

APPLIED: PER CENTURION STONE VENEER
INSTALLATION PROCEDURES REFERENCE
ICC ES REPORT ESR-2239 FOR SPECIFIC CODE
REQUIREMENTS

NOTE: BE SURE TO BED ALL COVERS AND FLANGES
IN SEALANT BEFORE FASTENING TO WALL.

NOT TO SCALE



Centurion Products, LLC.
7201 Cockrill Bend Blvd
Nashville, TN 37209
www.Centurionstone.com

COACH LIGHT TRIM

K3