

SPECIFICATIONS:

APPLIED: PER CENTURION STONE VENEER
INSTALLATION PROCEDURES REFERENCE
ICC ES REPORT ESR-2239 FOR SPECIFIC
CODE REQUIREMENTS

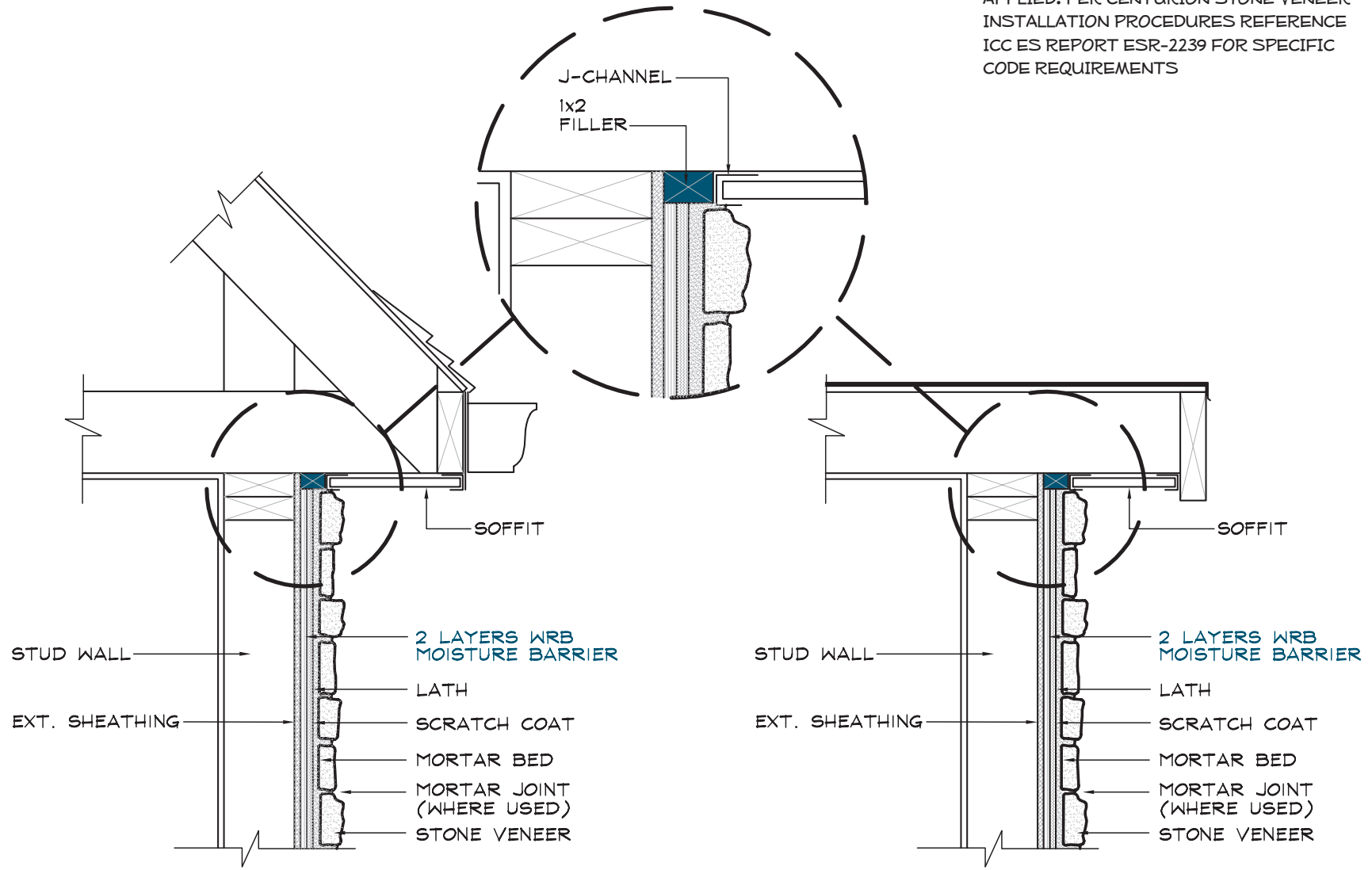

STANDARD EAVE DETAIL

RAKE WITH OVERHANG DETAIL

NOT TO SCALE



Centurion Products, LLC.
7201 Cockrill Bend Blvd
Nashville, TN 37209
www.CenturionStone.com

STANDARD EAVE DETAIL

A1