

MORTAR BED  
 STONE VENEER  
 MORTAR JOINT  
 (WHERE USED)

SHUTTER  
 SHUTTER STRIP  
 ALLOWS FOR A FLAT  
 AND LEVEL SHUTTER  
 MOUNTING

STUD WALL  
 EXT. SHEATHING  
 MOISTURE BARRIER

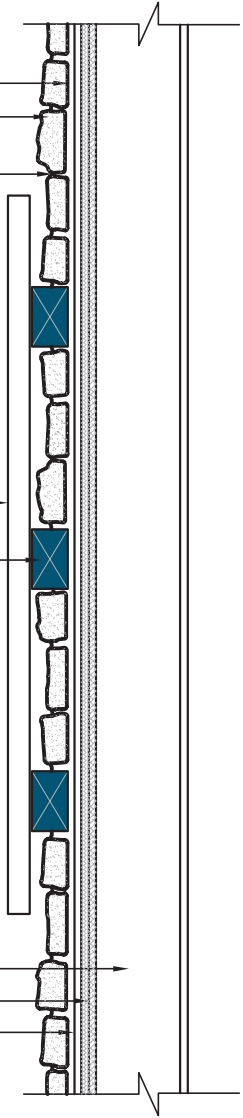

**SPECIFICATIONS:**

APPLIED: PER CENTURION STONE VENEER  
 INSTALLATION PROCEDURES REFERENCE  
 ICC ES REPORT ESR-2239 FOR SPECIFIC CODE  
 REQUIREMENTS

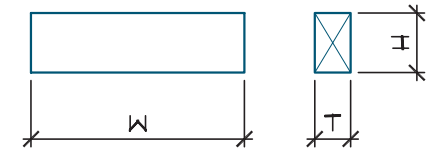

**SHUTTER STRIP:**

PATTERN - SHUTTER STRIP  
 TEXTURE - SMOOTH FACE  
 CODE - P810  
 THICKNESS - 2"  
 HEIGHT - 4"  
 WIDTH - 14"

**PACKAGING:**

PIECES - 126  
 WEIGHT - BOX - 1134LBS  
 WEIGHT - PIECE - 9LBS

NOT TO SCALE



Centurion Products, Inc.  
 50 Van Buren Street  
 Nashville, TN 37208  
 www.CenturionStone.com

**SHUTTER STRIP**

K5