

COACH LIGHT TRIM P 885/P887

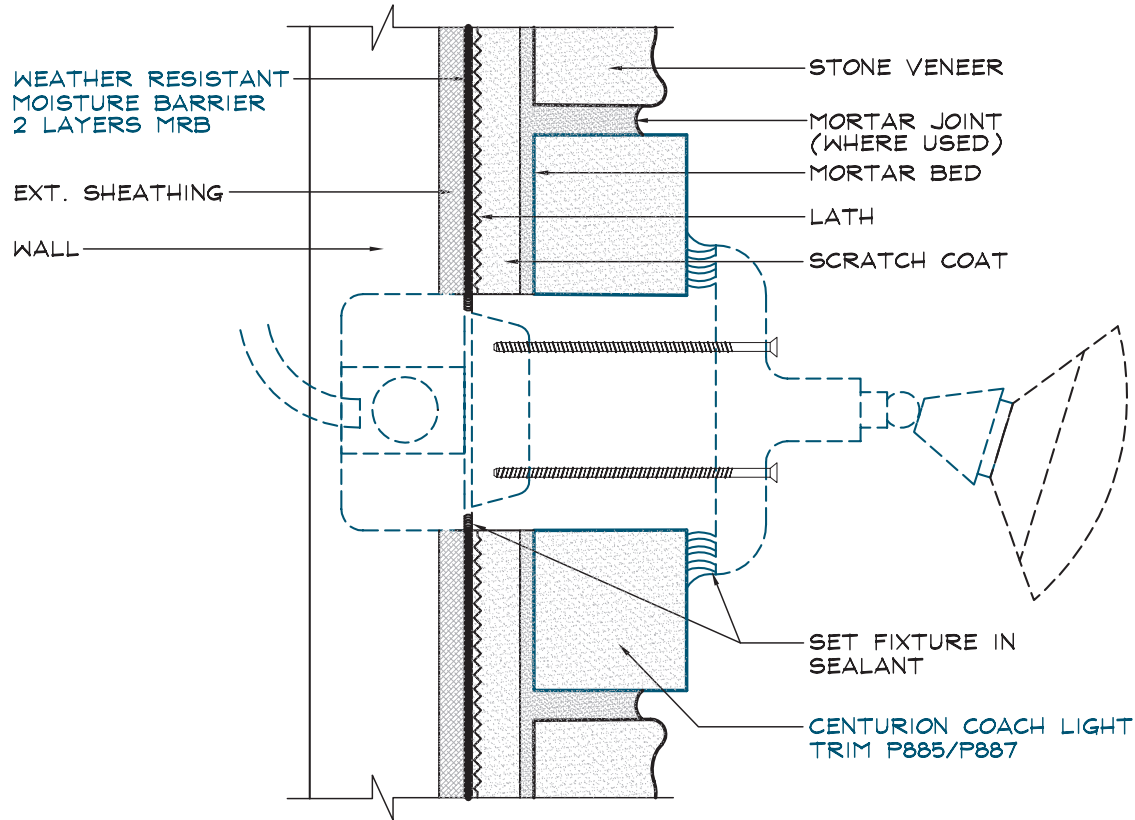

**SPECIFICATIONS:**

APPLIED: PER CENTURION STONE VENEER  
 INSTALLATION PROCEDURES REFERENCE  
 ICC ES REPORT ESR-2239 FOR SPECIFIC CODE  
 REQUIREMENTS

NOTE: BE SURE TO BED ALL COVERS AND FLANGES  
 IN SEALANT BEFORE FASTENING TO WALL.

NOT TO SCALE



Centurion Products, Inc.  
 50 Van Buren Street  
 Nashville, TN 37208  
[www.CenturionStone.com](http://www.CenturionStone.com)

**COACH LIGHT TRIM**

K3