

CMU WALL / STONE ON ONE SIDE

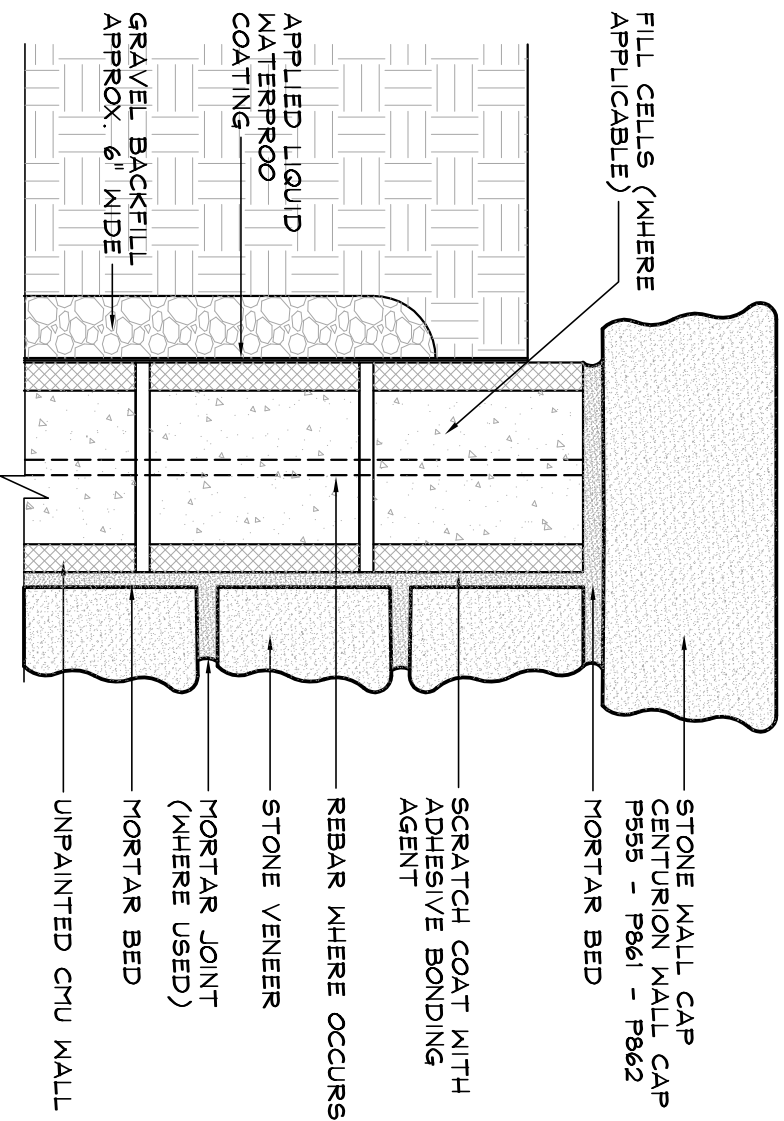

Specifications :

APPLIED : PER CENTURION STONE VENEER INSTALLATION PROCEDURES REFERENCE ICC ES REPORT ESR-2239 FOR SPECIFIC CODE REQUIREMENTS

OVER CLEAN MASONRY

NO SURFACE PREPARATION IS NECESSARY PROVIDED THE SURFACE IS CLEAN AND FREE OF CONTAMINATES SUCH AS DIRT, DUST, RELEASE AGENTS, SEALERS, AND FORM OILS.

NOTE : SEE CENTURION INSTALLATION PROCEDURES FOR REMOVING THESE CONTAMINATES.

CMU WALL	WALL CAP
8"	FLATCAP P555
	BEVELED CAP P861
12"	BEVELED CAP P862

NOT TO SCALE



Centurion Products, Inc
50 Van Buren Street
Nashville, TN 37208
www.centurionstone.com

CMU WALL / STONE ON ONE SIDE

K.0.1